

Legend

Soft Landscaping

- Tilia cordata*, circa. 5-6m tall at planting (Small-leaved lime tree)
- Acer platanoides*, circa. 5-6m tall at planting (Norway Maple)
- Sequoiadendron giganteum*, circa. 4m tall at planting (Giant Redwood)
- Pinus sylvestris*
- Quercus rubra* (Red oak)
- Specimen parkland trees
- Native tree species planted in hedgerows
- Terrestrial woodland planting at the entrance
- Beech hedegrow
- Native hedgerow
- Site boundary terrestrial woodland planting on screen berm
- Terrestrial woodland planting at hedgerow corners
- Grass mounds 1m tall
- Lonicera pileata* (Box-leaved honeysuckle)
- Grass seeded lawn
- Semi-natural Calcareous meadow
- Groundcover planting on the mound

Moodboard



NOTE:
1. This plan is to be read in conjunction with Biodiversity Management Plan (BMP) report as produced by Doherty Environmental Consultants, August 2018.
2. Additional SUDS components as outlined in BMP to be considered for all future developments

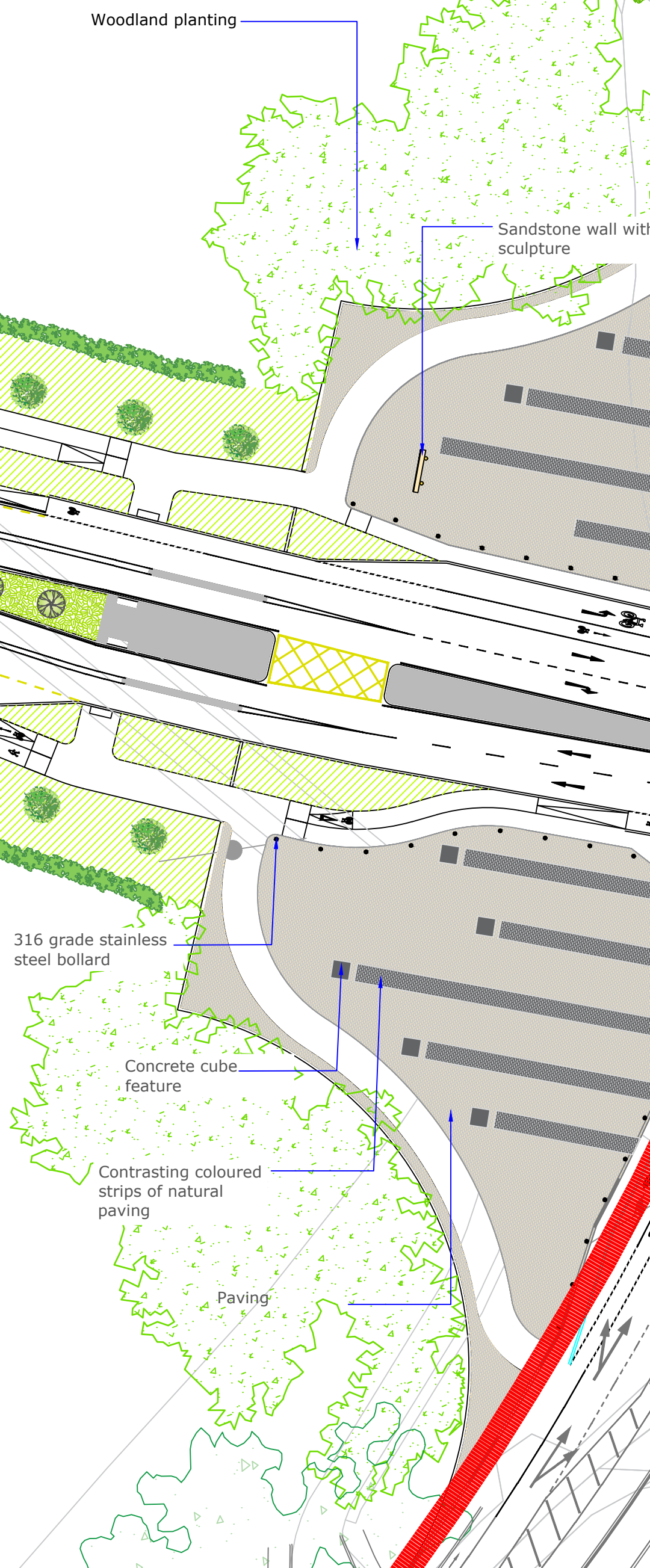

F	19/09/18	RB	Updated entrance detail
E	31/08/18	DB	Updated landscape design
D	19/07/18	DB	Updated landscape design
C	19/07/18	DB	Updated roundabout design
B	17/06/18	DB	Updated Landscape Plan
A	08/06/18	EOD	Landscape Plan
Rev	Date	By	Details

AUSTEN ASSOCIATES
One Salt House, South Quay, Wicklow Town, Co. Wicklow
T: 0404 66627
Email: designdesk@austenassociates.ie | Web: www.austenassociates.ie
landscape architecture design project management
Copyright Austen Associates, 2018

Client:		South Dublin County Council	
Project title:		Grangecastle West	
Drawing title:		Landscape Plan-Main Avenue	
Drawn by:	RB	Scale:	As shown on A1
Approved by:	TA	Date:	Sept. 2018
Status:	Planning	Drawing no:	042817_LP_01
		Revision:	F