

SECTION AA': COURTYARD 1

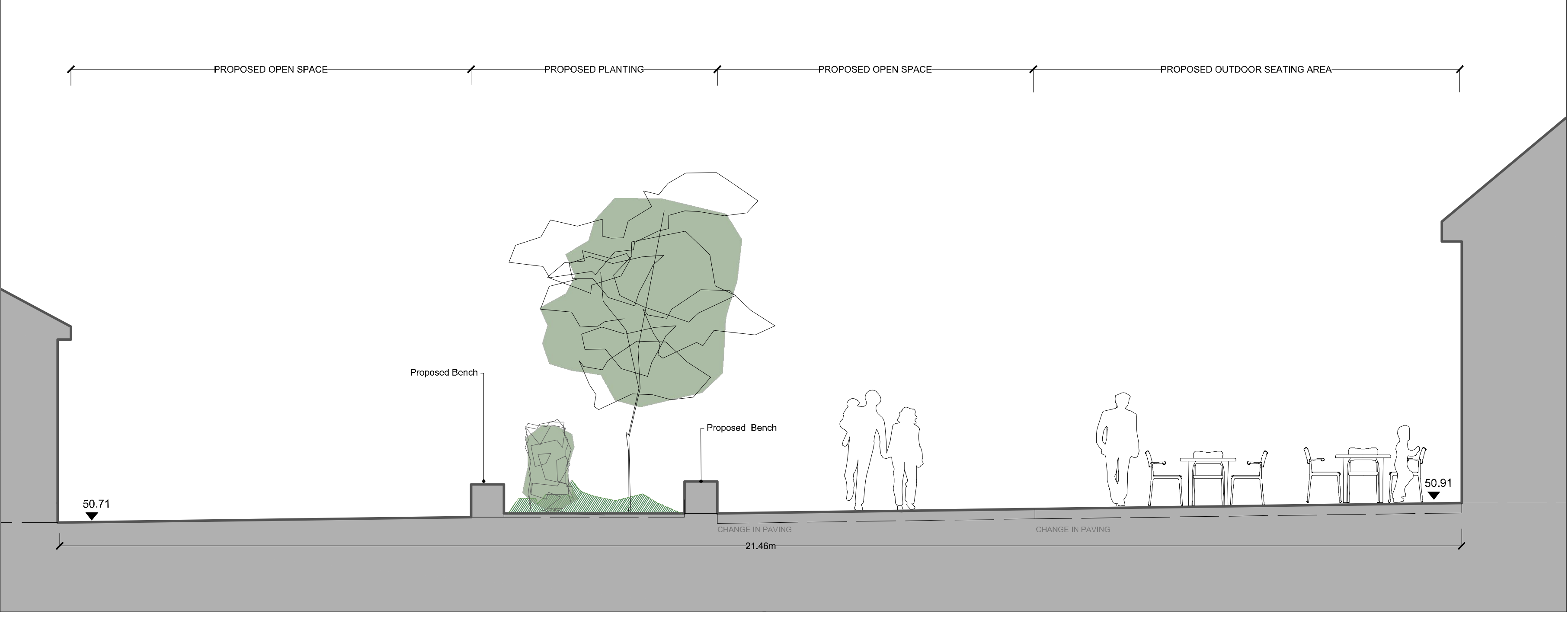

SECTION BB': COURTYARD 2

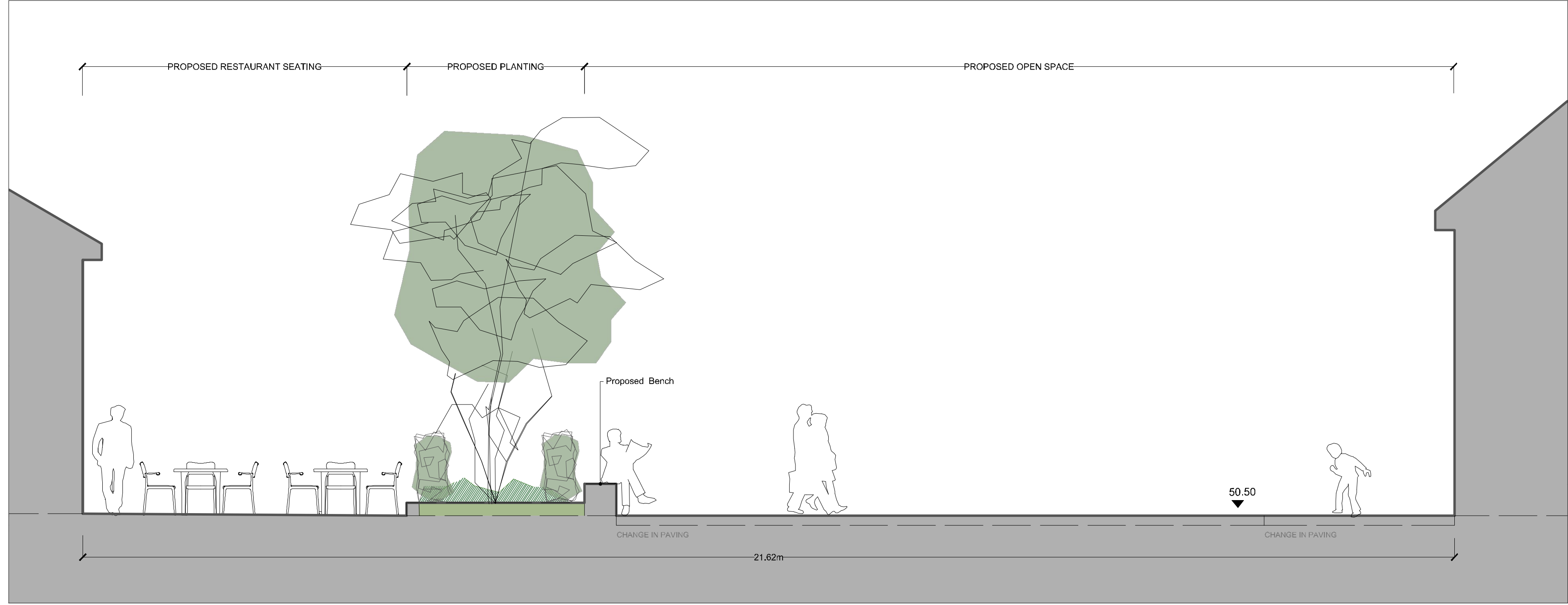

SECTION CC': COURTYARD 3

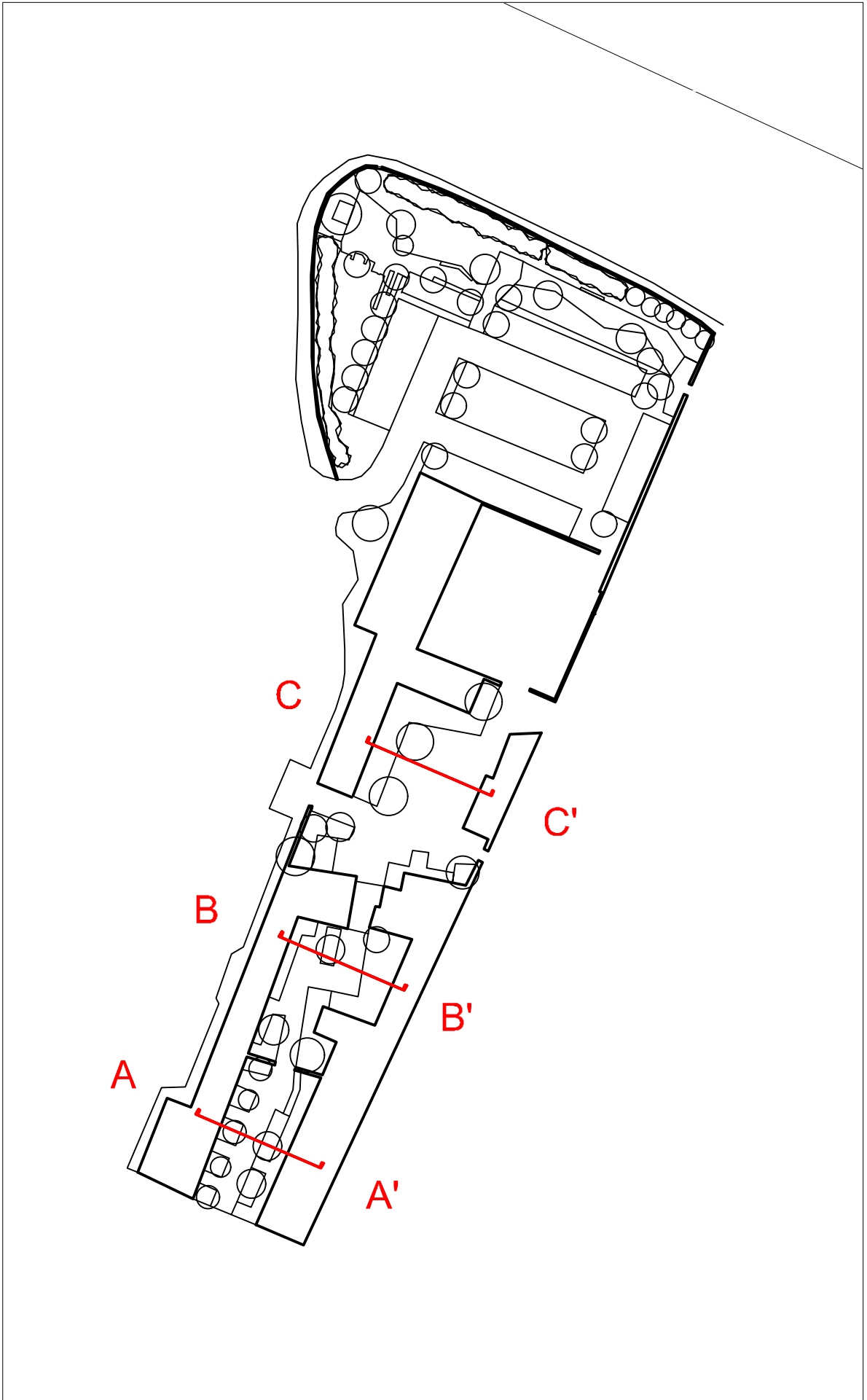

SECTION KEY (1:1000)

This drawing is the copyright of the Landscape Architect. Unless otherwise stated all dimensions are in millimetres. Where dimensions are not given, drawings must not be scaled and the matter must be referred to the Landscape Architect. If the drawing includes conflicting details/dimensions the matter must be referred to the Landscape Architect. All dimensions must be checked on site. The Landscape Architect must be informed, by the Contractor, of any discrepancies before work proceeds.

NOTES:

DATE	REV	DESCRIPTION	DRAWN BY	CHECKED BY
-	-	-	-	-

CLIENT: SOUTH DUBLIN COUNTY COUNCIL					ISSUE STATUS:	
PROJECT: RATHFARNHAM CASTLE - STABLES AND COURTYARDS					PLANNING	NORTH REVISION -
DRAWING: LANDSCAPE SECTIONS 01					DRAWING NO. Sd.05-DR-2400	
PROJECT NO Sd.05	SCALE 1:50	SHEET SIZE A1	DRAWN BY ak	CHECKED BY JB	1st ISSUE 11.01.2025	