



NORTH-WEST ELEVATION
SCALE: 1 : 100

GENERAL NOTES

DO NOT SCALE FROM DRAWINGS. WORK TO FIGURED DIMENSIONS ONLY. ARCHITECT TO BE NOTIFIED OF ANY DISCREPANCIES.

THIS DRAWING TO BE READ IN CONJUNCTION WITH ALL ARCHITECT'S DRAWINGS, SPECIFICATIONS CONSULTANTS DESIGN TEAM DRAWINGS AND SPECIFICATIONS.

MATERIALS AND FINISHES:

1. Red Clay brick.
2. Light buff grey brick.
3. Rendered Panels.
4. Powder coated external frame to glazed screen- Colour to match metal goods.
5. Grey Tiles to Pitched Roofs.
6. Metal balcony - colour to match metal goods throughout.

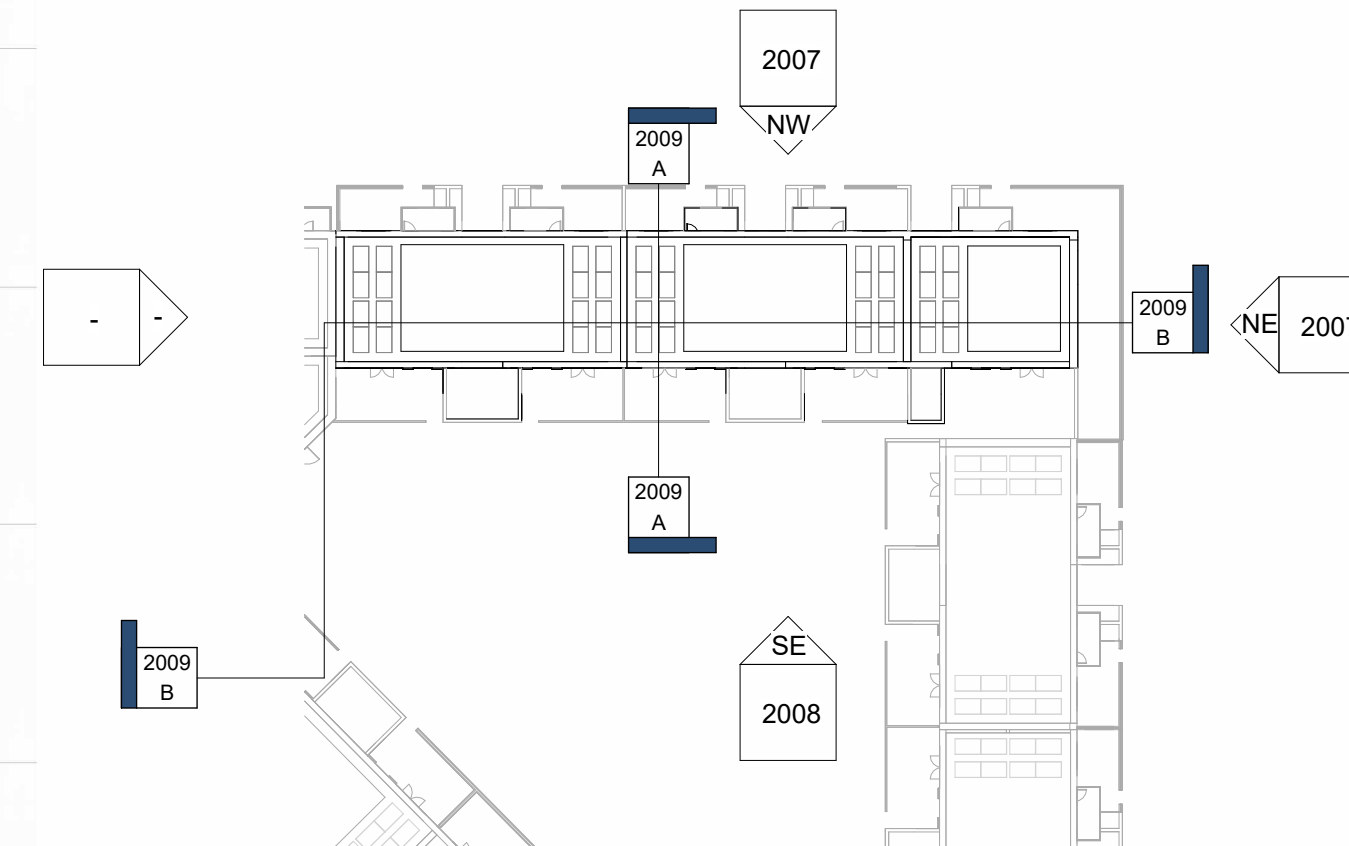

KEY PLAN - ELEVATIONS SHEET 01
SCALE: 1 : 500



NORTH-EAST ELEVATION
SCALE: 1 : 100

REV	DATE	DESCRIPTION	ISSUED BY
A	28/06/2024	General Updates	JH

FOR PLANNING

CLIENT:
NDFA on behalf of South Dublin County Council

PROJECT TITLE:
Proposed Part 8 Residential Development Kishoge, Lucan

DUPLEX TERRACE 1- ELEVATIONS SHEET 01

DRN BY:	CHK BY:	SCALE @ A1:	DATE:	REVISION:	JOB NO:
JH	PMcN	1:100	28/06/2024	A	23004
DRAWING NUMBER:	STATUS CODE:				
SHB5-CSD-DR-MCORM-AR-P3-2007	P3				

MCORM
ARCHITECTURE
AND URBAN DESIGN

No.1 Grantham Street, Dublin 8
D08 A69Y Tel: +353 (0)1 478 6700
Block 6, Central Business Park
Tullamore, County Offaly
R35 F6F8 Tel: +353 (057) 932 3867
website: www.mcorm.com
email: arch@mcorm.com

Figured dimensions only to be used. This drawing is copyright of MCORM Ltd. All information is shared as per approved use in accordance with I.S.144:2021 to I.S. EN ISO 19550-2: 2018, if 'Status Code' above is empty, this information has been shared as Status Code S0 - Work in Progress (WIP) / Draft.