

NOTES

DO NOT SCALE - USE FIGURED DIMENSIONS ONLY.
 ALL DIMENSIONS TO BE CHECKED ON SITE PRIOR TO CONSTRUCTION AND ANY DISCREPANCIES TO BE HIGHLIGHTED BY CONTRACTOR.
 THIS DRAWING IS TO BE READ IN CONJUNCTION WITH ALL RELEVANT SPECIFICATIONS AND DRAWINGS.
 ALL LEVELS ARE TO FINISHED LEVELS UNLESS OTHERWISE INDICATED.
 ALL SETTING OUT AND DIMENSIONS TO BE AGREED ON SITE BASED ON CONSTRUCTION DRAWINGS.

LEGEND

- Intervention Area
- To be Demolished
- To be Removed

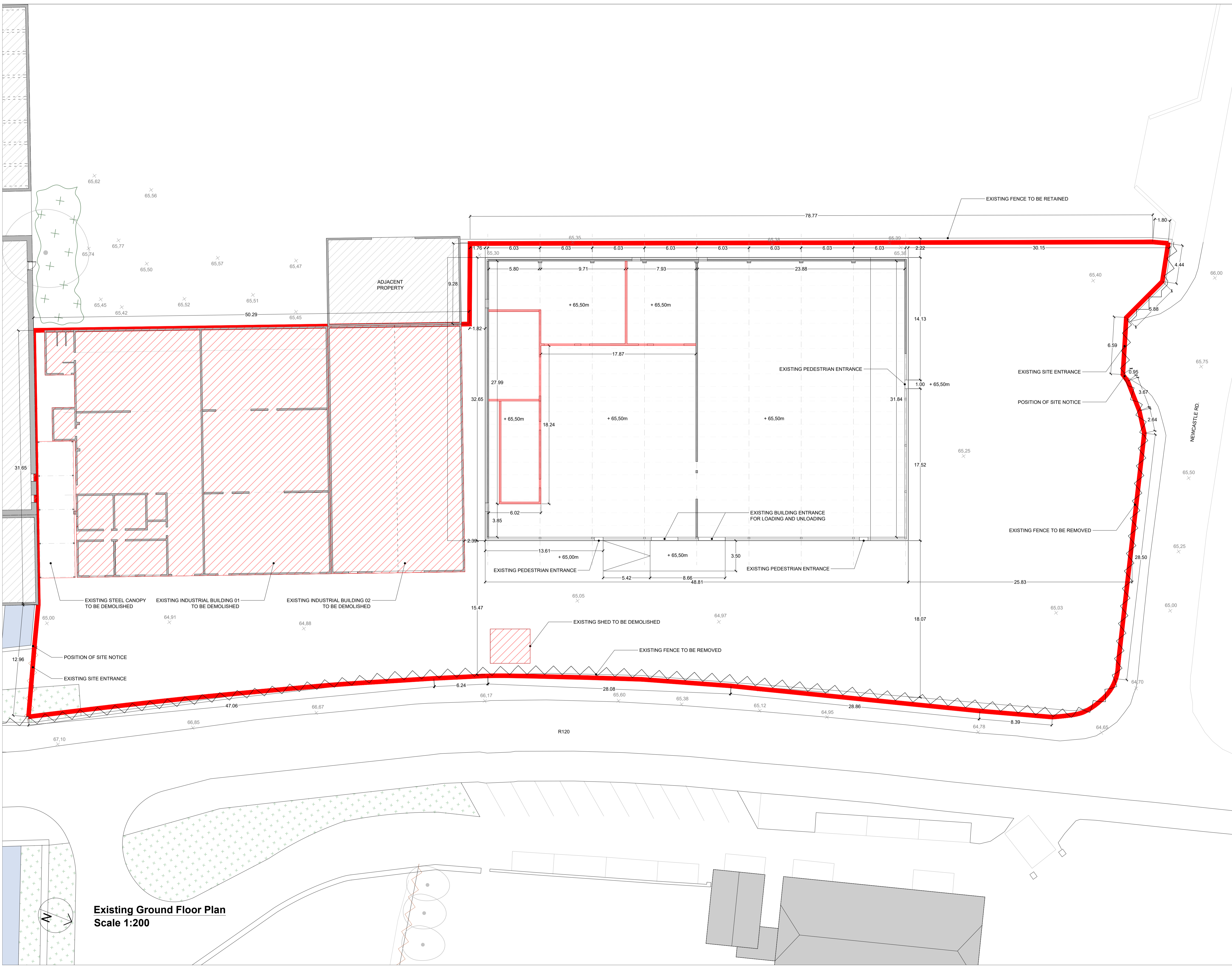

Existing Ground Floor Plan
 Scale 1:200

| Rev. | Date | Description | By |
|------|------|-------------|----|
| | | | |

SFA42
 ARCHITECTS

Ballalease North, Donabate
 DUBLIN K36 HP22 Ireland
 T: +353 1 8438 937 stephen@sfa42.ie

Katrina Vasira Kyrkogata 8
 116 25 STOCKHOLM Sweden
 T: +46 738 42 46 67 johan@sfa42.ie

www.sfa42.ie

Client:
 SOUTH DUBLIN COUNTY COUNCIL

Project:
 12th LOCK STUDIOS

Drawing no.
E-003

Drawing Title:
 Existing Ground Floor Plan

Drawing Status:
 PLANNING APPLICATION

Drawn by: SA Checked by: SF Approved by: SF

Scale:
 1:200 @ A1 Date: 26/02/24
 1:400 @ A3