

LEGEND

SITE BOUNDARY	
EXISTING STORM DRAINAGE	
ASSUMED EXISTING STORM DRAINAGE	
PROPOSED STORM DRAINAGE 225Ø UNO	
PROPOSED FILTER DRAIN 225Ø UNO	
PROPOSED STORM MANHOLE	
AREA OF PERMEABLE PAVING	
SUDS TREE PITS	
PROPOSED SOFT LANDSCAPING	
PROPOSED RAIN GARDEN	
EXISTING ROAD TO BE RETAINED	

- NOTES**
1. ALL NOTED LEVELS ARE TO ORDNANCE DATUM, MALIN HEAD.
 2. REFER TO ARCHITECT'S LAYOUT FOR ALL SET-OUT INFORMATION.
 3. ALL SURFACE WATER DRAINAGE IS TO BE INSTALLED IN ACCORDANCE WITH THE GREATER DUBLIN REGION CODE OF PRACTICE FOR DRAINAGE WORKS, THE BUILDING REGULATIONS PART H AND THE SITE DEVELOPMENT SPECIFICATION.
 4. ALL DRAINAGE COVER LEVELS ARE TO BE COORDINATED WITH THE PROPOSED ROAD DESIGN LEVELS AND ARCHITECT DESIGN FINISH DETAILS.
 5. ALL CONNECTIONS TO NEW DRAINAGE NETWORKS ARE TO BE MADE AT AN ANGLE OF 90° OR IN THE DIRECTION OF FLOW.
 6. THE CONTRACTOR IS TO VERIFY INVERT LEVEL AT PROPOSED CONNECTION TO EXISTING SEWERS, PRIOR TO ANY OTHER WORKS BEING CARRIED OUT, AND MAKE ANY DISCREPANCIES KNOWN TO THE ENGINEER.
 7. THE CONTRACTOR IS RESPONSIBLE FOR CONFIRMATION OF PRESENCE ALL EXISTING UTILITIES, IF ANY, ALONG ROUTE OF PROPOSED DRAINAGE NETWORKS - BY INTRUSIVE INVESTIGATION OR EQUAL.
 8. EXISTING PUBLIC SEWER TO BE JET CLEANED AND CCTV SURVEYED PRIOR TO, AND AFTER PROPOSED CONNECTIONS FROM NEW NETWORK.
 9. ALL NEW DRAINAGE INFRASTRUCTURE TO BE JET CLEANED AND CCTV SURVEYED, WITH ANY NOTED DEFECTS REMEDIATED, ON COMPLETION OF WORKS, TO THE SATISFACTION OF THE LOCAL AUTHORITY.
 10. ALL COVER LEVELS ARE TO BE COORDINATED WITH ROAD DESIGN LEVELS AND ARCHITECT'S PROPOSED LEVELS.
 11. ALL DISCHARGE MANHOLES TO BE VENTED.
 12. ALL GULLIES TO BE TRAPPED.
 13. AS CONSTRUCTED DRAWING AND MODEL TO BE PROVIDED ON COMPLETION OF ALL WORKS.
 14. ALL NEW PIPE WORK TO BE UPVC PIPE WORK IN ACCORDANCE WITH REQUIREMENTS OF SDCC AND IRISH WATER UNLESS NOTED OTHERWISE.

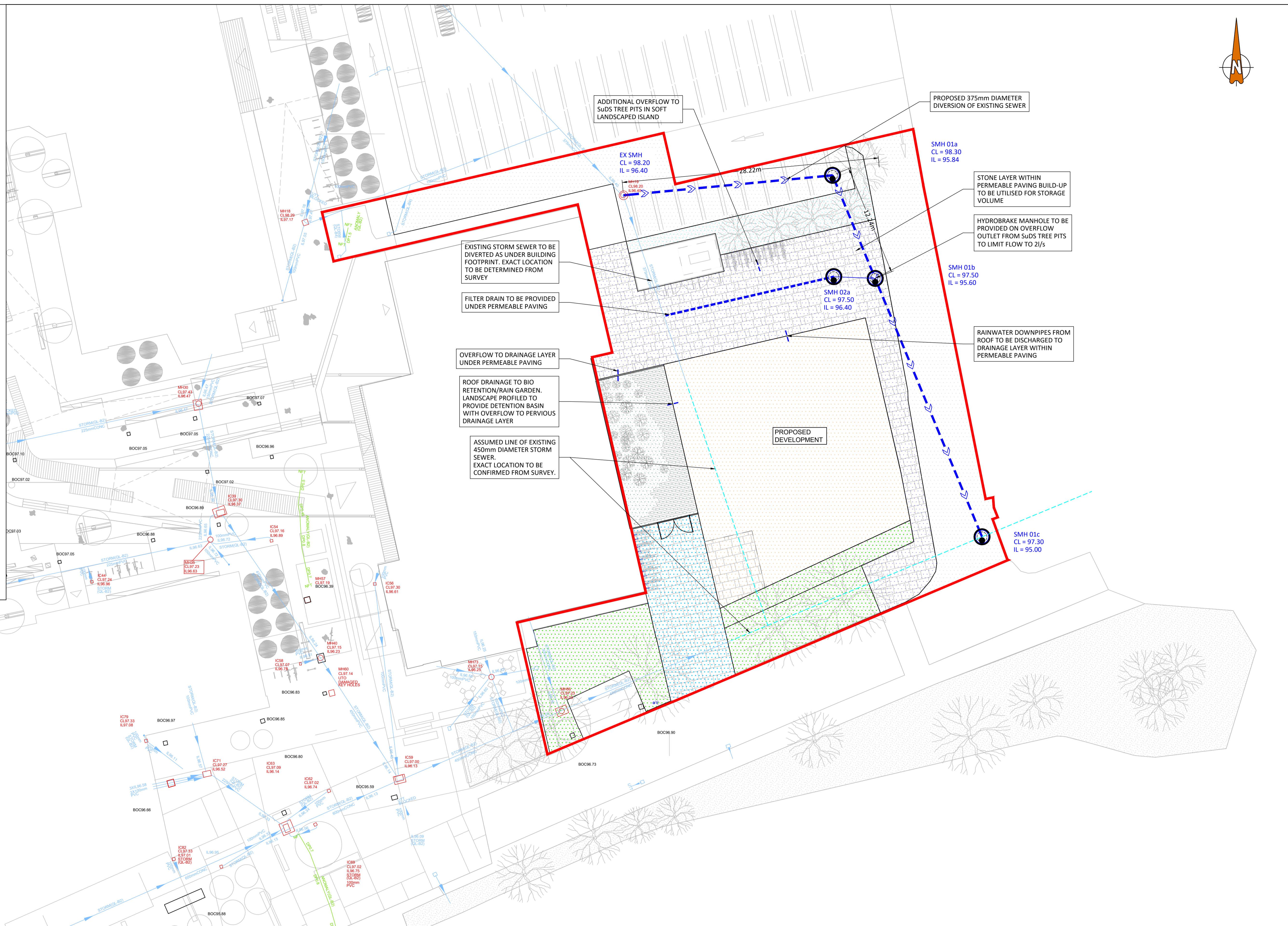

- THIS DRAWING TO BE READ IN CONJUNCTION WITH ALL OTHER RELEVANT DESIGN TEAM DRAWINGS AND SPECIFICATIONS.
- FOR SETTING OUT REFER TO ARCHITECT'S DRAWINGS. DO NOT SCALE THIS DRAWING. USE FIGURED DIMENSIONS ONLY.
- NO PART OF THIS DOCUMENT MAY BE REPRODUCED OR TRANSMITTED IN ANY FORM OR STORED IN ANY RETRIEVAL SYSTEM OF ANY NATURE WITHOUT THE WRITTEN PERMISSION OF O'CONNOR SUTTON CRONIN AS COPYRIGHT HOLDER EXCEPT AS AGREED FOR USE ON THE PROJECT FOR WHICH THE DOCUMENT WAS ORIGINALLY ISSUED.

Rev No.	Date	Revision Note	Drn by	Chkd by
P01	02.08.23	SUITABLE FOR STAGE APPROVAL	MC	IC
P02	03.08.23	SUITABLE FOR STAGE APPROVAL	MC	IC

Rev No.	Date	Revision Note	Drn by	Chkd by



OCSC
O'CONNOR SUTTON CRONIN
 MULTIDISCIPLINARY CONSULTING ENGINEERS
 Civil / Structural / Environmental / Mechanical / Electrical / Sustainability
 Dublin Office: 9 Prussia Street, Dublin 7. D07 KT57.
 Tel: +353 (0)1 8682000 Web: www.ocsc.ie
 Dublin London Belfast Galway Cork Birmingham

Client: SOUTH DUBLIN COUNTY COUNCIL								
Project: TALLAGHT HERITAGE CENTRE								
Title: PROPOSED STORM DRAINAGE LAYOUT								
Code	Originator	Zone	Level	Type	Role	Number	Status	Revision
M1381	OCSC	XX	XX	DR	C	0500	S4	P02
Date: JULY '23 Scale @ A1: 1:200		Drn by: MC		Chkd by: IC		Aprvd by: AH		