

1

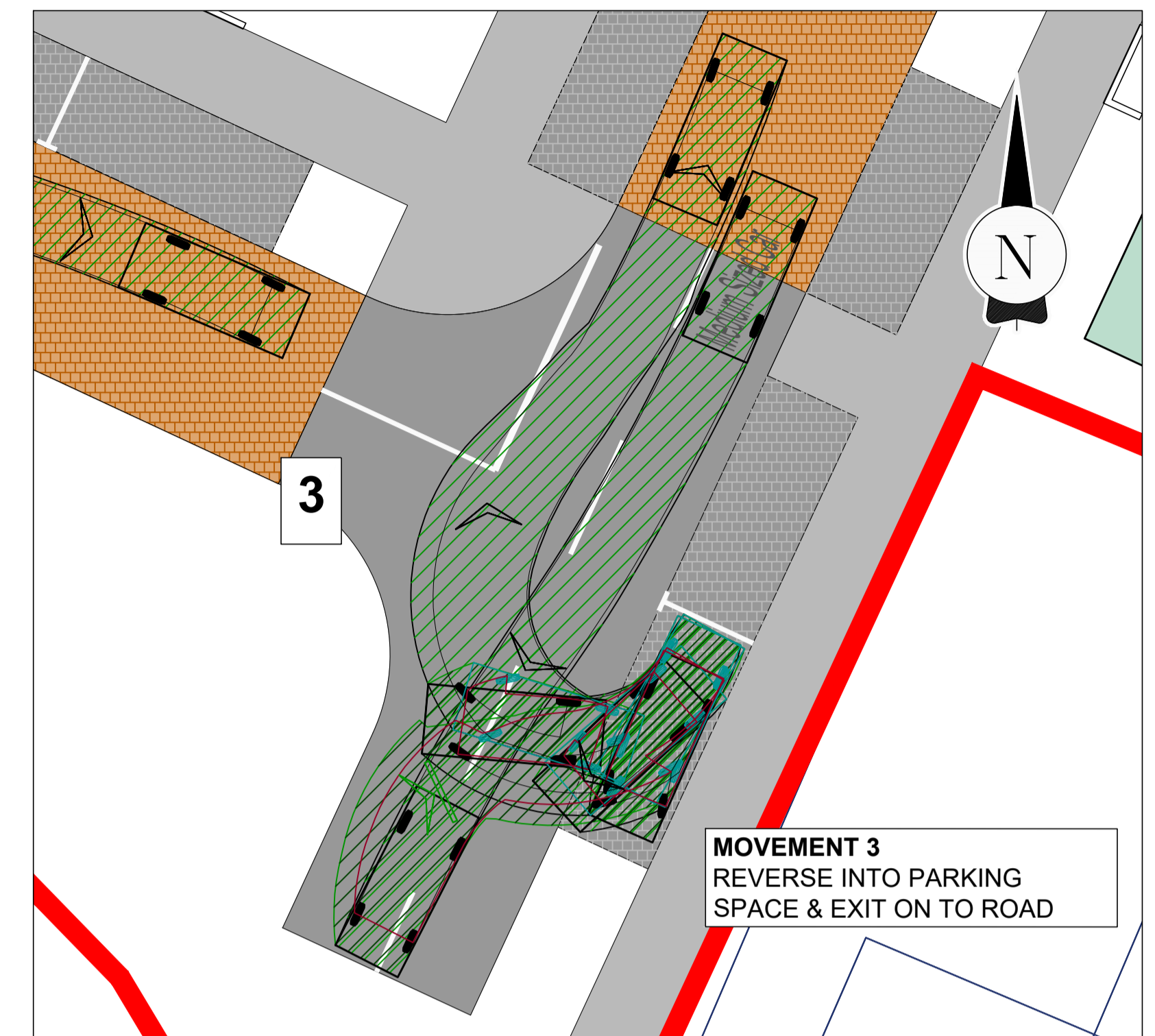

2



3

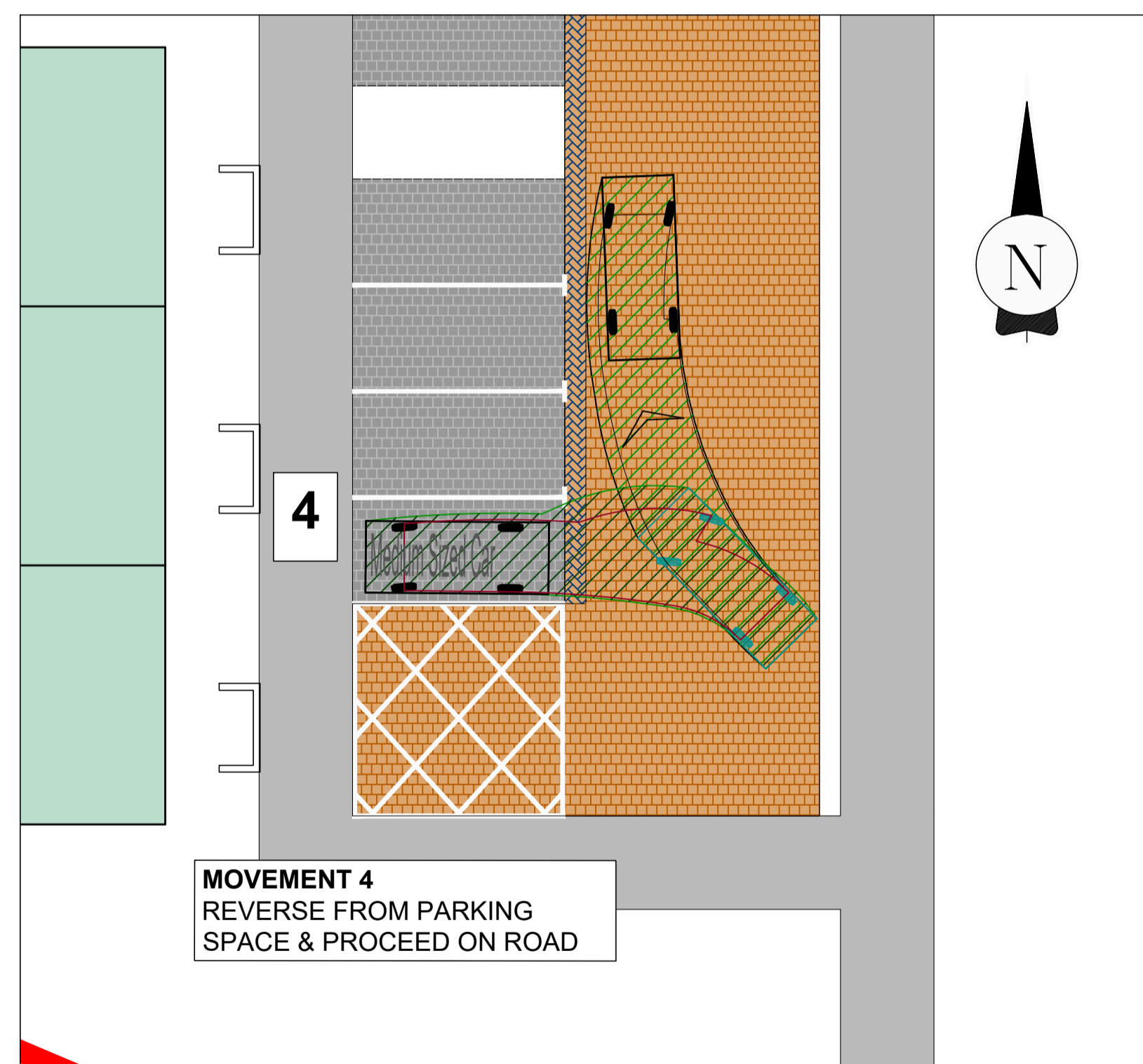

4

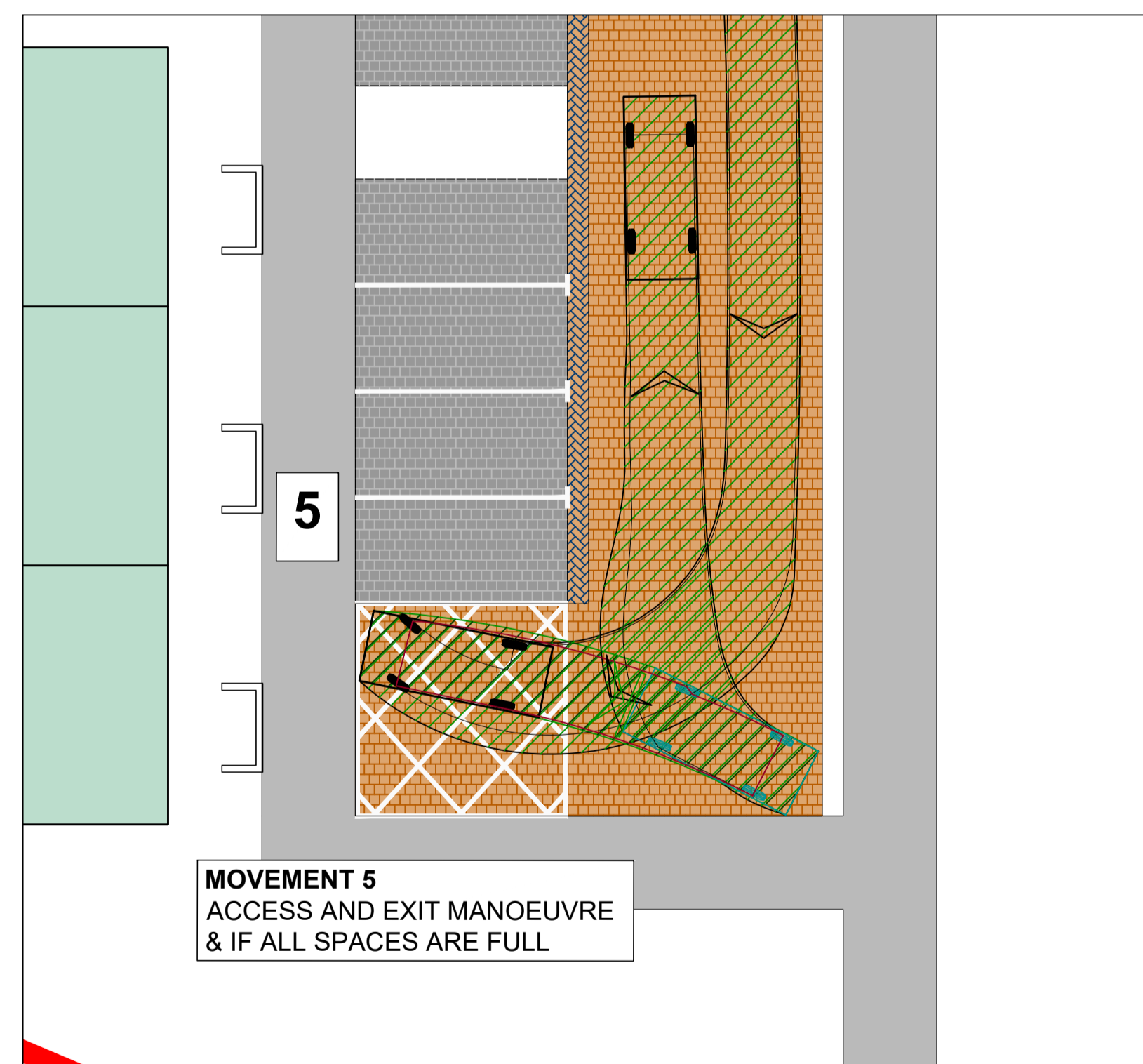

5

Medium Sized Car	
Overall Length	4.319m
Overall Width	1.686m
Overall Body Height	1.466m
Min Body Ground Clearance	0.228m
Max Track Width	1.591m
Lock to lock time	4.00s
Kerb to Kerb Turning Radius	5.042m

Vehicle type

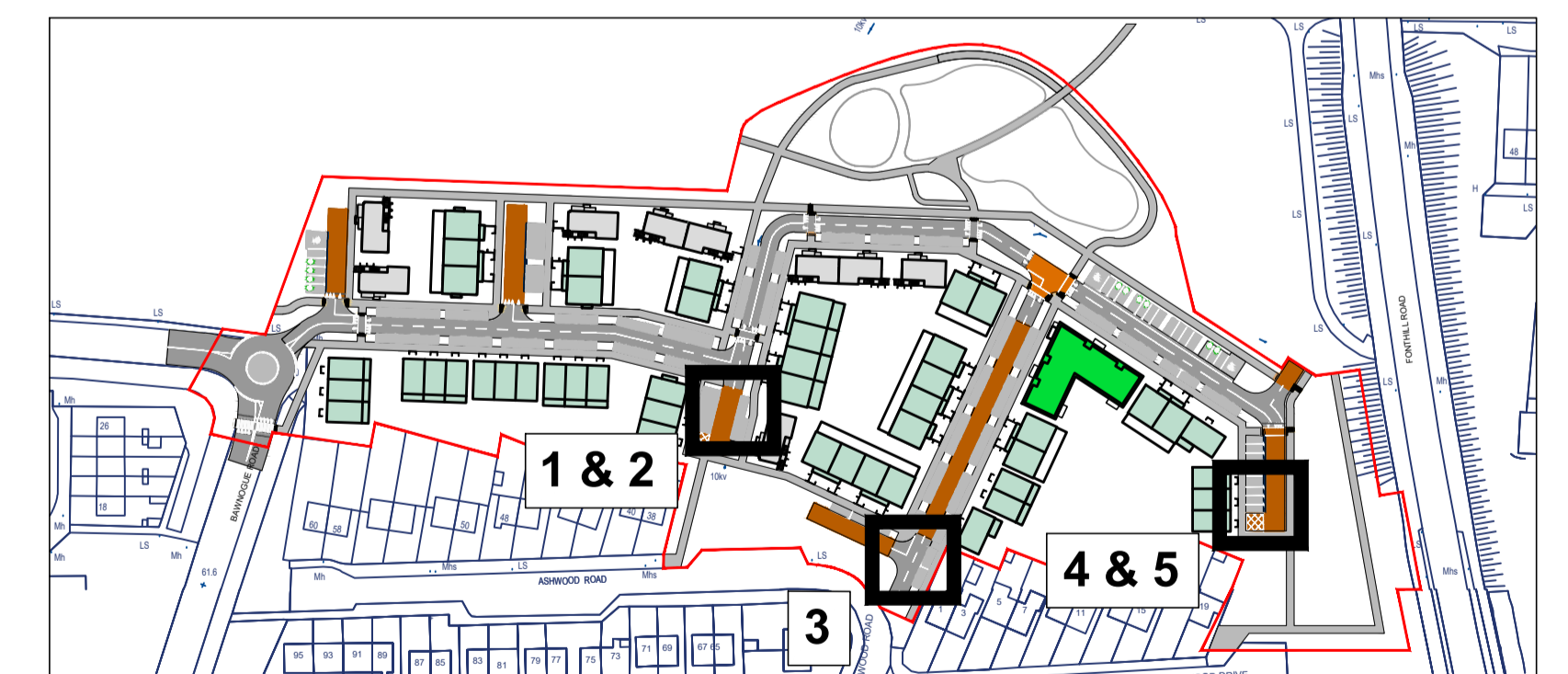

Key

Client:



Architect:



General Notes

(i) Hard copies, dwf and pdf will form a controlled issue of the drawing. All other formats (dwg etc.) are deemed to be an uncontrolled issue and any work carried out based on these files is at the recipients own risk. RPS will not accept any responsibility for any errors from the use of these files, either by human error by the recipient, listing of the un-dimensioned measurements, compatibility with the recipients software, and any errors arising when these files are used to aid the recipients drawing production, or setting out on site.

(ii) DO NOT SCALE, use figured dimensions only.

(iii) This drawing is the property of RPS, it is a project confidential classified document. It must not be copied used or its contents divulged without prior written consent. The needs and expectations of client and RPS must be considered when working with this drawing.

(iv) Information including topographical survey, geotechnical investigation and utility detail used in the design have been provided by others.

(v) All Levels refer to Ordnance Survey Datum, Malin Head.

Rev	Date	Drawn By	Amendment / Issue	App
A1	14.03.22	PH/MD	ISSUE FOR PLANNING	CW

**RPS** MAKING COMPLEX EASY  
 West Pier  
 Business Campus  
 Dun Laoghaire  
 Co. Dublin A96 N6T7  
 T +353 (0)1 4882900  
 W www.rpsgroup.com/ireland  
 E ireland@rpsgroup.com

Scale	1:125 @ A1 1:250 @ A3
Created on	16/11/2022
Sheets	1 OF 1

Project **CANAL EXTENSION - CLONBURRIS**

Title **CAR ACCESS (AUTOTRACK) SHEET 1**

File Identifier	MDC0709-RPS-00-XX-DR-C-DG2013.dwg	Status	A1	Rev	C01
-----------------	-----------------------------------	--------	----	-----	-----