

SITE LIGHTING INSTALLATION NOTES

- 1.00 LIGHTING POLES TO BE ALUMINIUM, ROOT MOUNTED, CONE SHAPED WITH TOP TAIL OF Ø60mm c/w CLASS II 4x16mm² SHUNT TERMINAL CONNECTION BLOCK.
- 2.00 ALL CABLING TO EXTERNAL LIGHTING LOCATIONS TO BE WIRED IN 3 Core 6mm² CU/XLPE/SWALSOH CONTAINED IN HDPE DUCTS.
- 3.00 ALL IN-GROUND HDPE DUCTS TO BE INSTALLED BY THE MAIN CONTRACTOR UNDER THE COORDINATION OF THE ELECTRICAL CONTRACTOR.
- 4.00 THE ELECTRICAL CONTRACTOR SHALL, PRIOR TO THE INSTALLATION, VERIFY THE CAPACITY OF THE IN-GROUND DUCT NETWORK TO THE MAIN CONTRACTOR.
- 5.00 EACH EXTERNAL LIGHTING LUMINAIRE SHALL BE SWITCHED BY MINIATURE PHOTO-ELECTRONIC SWITCH INTEGRATED INTO THE LED LUMINAIRE SUCH AS THE SELC 8482 OR APPROVED EQUAL AND EACH LUMINAIRE SHALL BE INDIVIDUALLY CONTROLLED BY THIS PHOTOCELL.
- 6.00 THE PHOTOCELL USED SHALL COMPLY WITH THE LATEST VERSION OF BS5972. THE PHOTOCELL CONTROLL SHALL SWITCH ON/OFF THE LUMINAIRE AT 35 / 18 LUX RESPECTIVELY.
- 7.00 ALL OUTGOING CIRCUITS SHALL BE INDIVIDUALLY FUSED BY MEANS OF A 16A OR 20A HRC CUT-OUT TYPE AND CAPABLE OF ACCOMMODATING CABLE SIZES UP TO 25mm². THESE FUSES SHALL BE RATED 20kA MINIMUM RUPTURING CAPACITY AND SHALL COMPLY WITH BS88.
- 8.00 ALL COLUMNS ARE SUPPLIED FROM A LIGHTING MINI-SECTION PILLAR, LOCATED ADJACENT TO THE ESB NETWORKS MINI-SECTION PILLAR. NOT MORE THAN 6 COLUMNS SHALL BE SUPPLIED FROM ANY ONE CIRCUIT AND NOT MORE THAN 4 CIRCUITS SHALL BE TAKEN FROM ANY ONE AUXILIARY MINI-SECTION PILLAR.
- 9.00 THE CONTRACTOR SHALL MAKE A FULL TECHNICAL SUBMITTAL TO THE DESIGN TEAM FOR ALL EXTERNAL LIGHTING FOR APPROVAL PRIOR TO ORDERING.
- 10.00 THE DEVELOPER SHALL NOTE THAT NO EXISTING PUBLIC LIGHTS CAN BE REMOVED WITHOUT THE PERMISSION AND APPROVAL OF PUBLIC LIGHTING SERVICES.
- 11.00 THE DEVELOPER SHALL CONTACT PUBLIC LIGHTING SERVICES AT LEAST 6 WEEKS IN ADVANCE OF WORKS STARTING ON SITE, TO FIND OUT WHAT IS REQUIRED TO BE DONE TO EXISTING PUBLIC LIGHTING THAT IS WITHIN THE SITE BOUNDARY.
- 12.00 ANY COSTS ASSOCIATED WITH THE RE-ARRANGEMENT OR ALTERATION OF EXISTING PUBLIC LIGHTING SHALL BE ENTIRELY AT THE DEVELOPER'S EXPENSE, INCLUDING ESB NETWORK COSTS.
- 13.00 WHERE PUBLIC ROADS ARE TO REMAIN IN USE, THEN THE PUBLIC LIGHTING MUST BE MAINTAINED BY THE DEVELOPER IN AN OPERATING CONDITION THROUGHOUT THE DEVELOPMENT PERIOD.

SITE LIGHTING REFERENCE KEY

- LIGHTING CIRCUIT
- X3 LED LANTERN LUMINAIRE (ROAD LIGHTING)
- X4 DECORATIVE POST-TOP LANTERN LUMINAIRE
- X5 LED BOLLARD LUMINAIRE
- X6 WALL MOUNTED BULKHEAD LUMINAIRE
- X7 GROUND RECESSED FLOODLIGHT
- X8 FLOODLIGHT LANTERN LUMINAIRE MOUNTED ON 10M COLUMN
- X9 POST-TOP LUMINAIRE
- X10 LED STRIP LIGHT
- LC LIGHTING COLUMN
- MCP LIGHTING MICRO-PILLAR

REF: 'X3' LUMINAIRES

15W, 2049LM, 2700K ROOT MOUNTED MAST LED LUMINAIRE MOUNTED @ 6m ON LIGHTING COLUMN.

DIMS: 568 (L) x 232 (W) x 149mm(H)

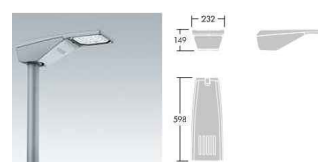

AS PER LUMINAIRE SCHEDULE

REF: 'X4' LUMINAIRES

21W, 2118lm, LED, 2700k, IP66 RATED, LED LUMINAIRE. POLE MOUNTED @ 4m.

DIMS: Ø700mm x 700mm(H)



AS PER LUMINAIRE SCHEDULE

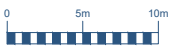
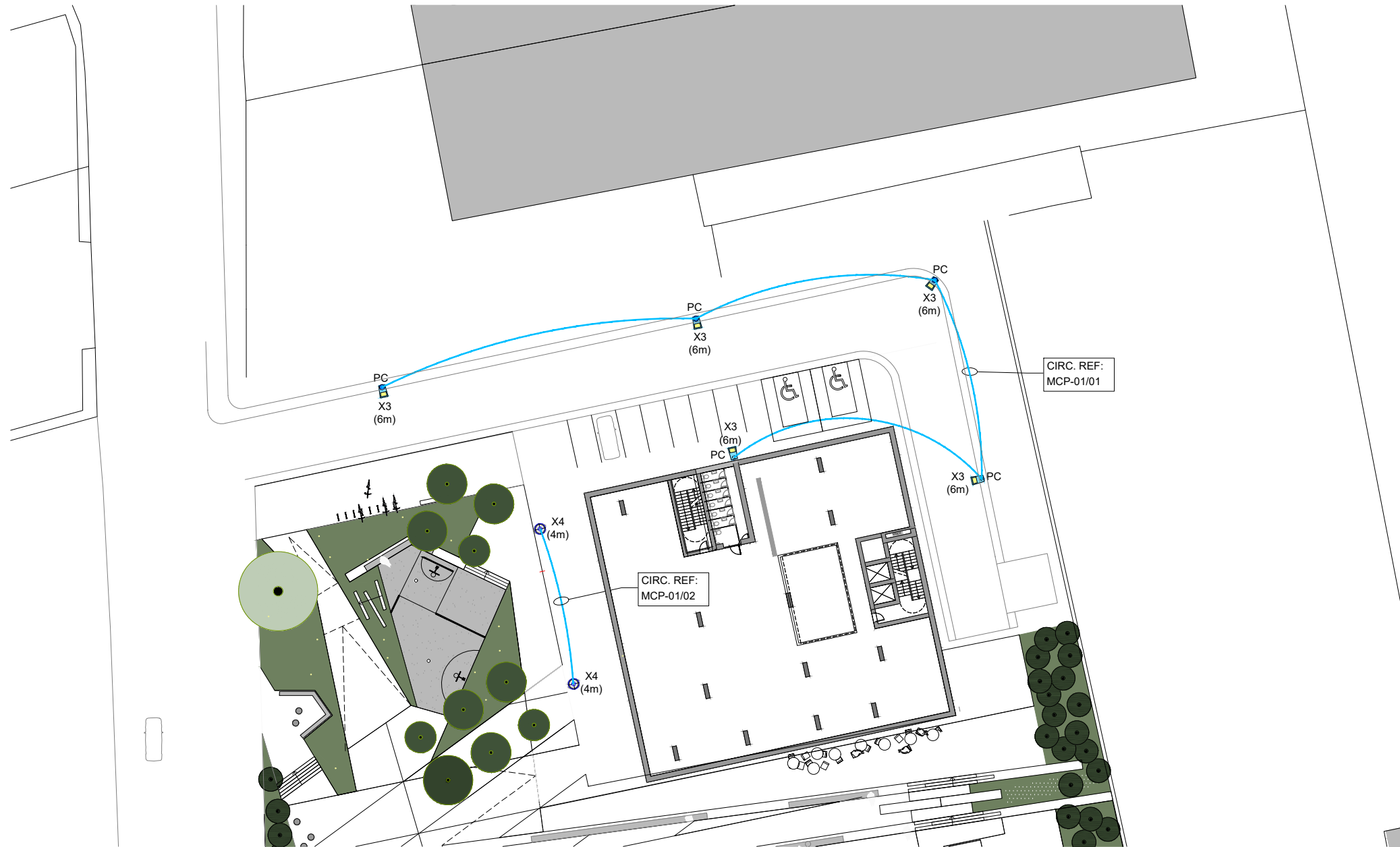

STATUS	DATE	DESCRIPTION	DRN	ENG	APP	REV

STATUS	DATE	DESCRIPTION	DRN	ENG	APP	REV
S2	14.09.2020	PRELIMINARY ISSUE	JL	LHC	TJ	P0.1