

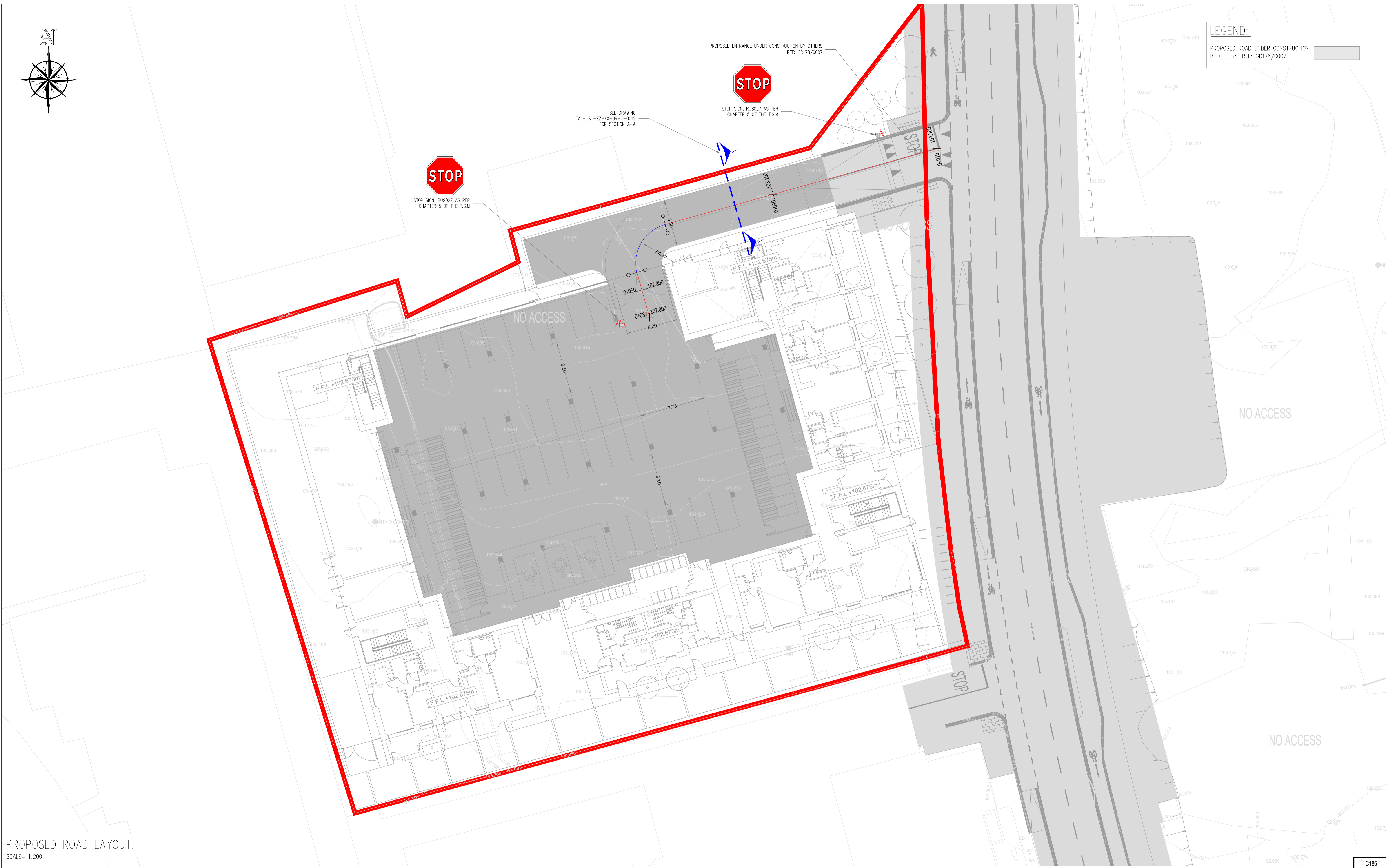

LEGEND:
 PROPOSED ROAD UNDER CONSTRUCTION BY OTHERS. REF: SD178/0007



PROPOSED ROAD LAYOUT.
 SCALE= 1:200

PLANNING DRAWING.
 NOT FOR CONSTRUCTION.
 ALL LEVELS GIVEN ARE
 RELATIVE TO ORDNANCE DATUM.
 THIS DRAWING HAS BEEN ISSUED FOR INFORMATION
 PURPOSES ONLY AND MUST NOT BE USED
 FOR CONSTRUCTION UNDER ANY CIRCUMSTANCES

- NOTES**
- For setting out refer to Architect's drawings.
 - This drawing to be read in conjunction with all other Architectural and Engineering drawings and all other relevant drawings and Specifications.
 - DO NOT SCALE THIS DRAWING. Use figured dimensions only.
 - No part of this document may be reproduced or transmitted in any form or stored in any retrieval system of any nature without the written permission as copyright holder except as agreed for use on the project for which the document was originally issued.
 - Ordnance Survey Ireland Licence Number EN 0074020

Rev. No.	Date	REVISION NOTE	Drn. By	Chkd. By

Architect	Coady Architects
Project	Belgard Square North Tallaght
Title	Proposed Road Layout
Dwg. No.	TAL-CSC-ZZ-XX-DR-C-0011
Date	28.04.2020
Drn. by	AB
Chkd. by	GS
Appr. by	NB
Scale	1:200 @A1
Revision	

CS Consulting Group
 DUBLIN | LONDON | LIMERICK

Head Office
 19-22 Dame Street, Dublin 2.
 T: +353 (0)1 5489863 F: +353 (0)1 9011355
 e: info@csconsulting.ie
 w: www.csconsulting.ie

Quality I.S. EN ISO 9001:2008
 Environment I.S. EN ISO 14001:2004
 Health & Safety I.S. EN ISO 50001:2011
 OHSAS 18001:2007