

- NOTES:
- ALL DRAWINGS TO BE CHECKED BY CONTRACTOR ON SITE AND ENGINEER INFORMED OF DISCREPANCIES BEFORE WORK COMMENCES
 - ALL LEVELS ARE IN METRES AND ARE RELATED TO ORDINANCE DATUM
 - CONTRACTOR SHALL SATISFY HIMSELF AS TO THE ACCURACY OF PAVEMENT LEVELS ON SITE PRIOR TO COMMENCEMENT OF WORKS ON SITE
 - ALL LINE MARKINGS & SIGNAGE TO COMPLY WITH THE D.O.T. TRAFFIC SIGNS MANUAL
 - ALTERATIONS TO THE PUBLIC FOOTPATHS & ROADS ADJACENT TO THE MAIN DEVELOPMENT ARE SUBJECT TO AGREEMENT WITH DUBLIN CITY COUNCIL

--- PROPOSED STORM SEWER
 --- PROPOSED FOUL SEWER

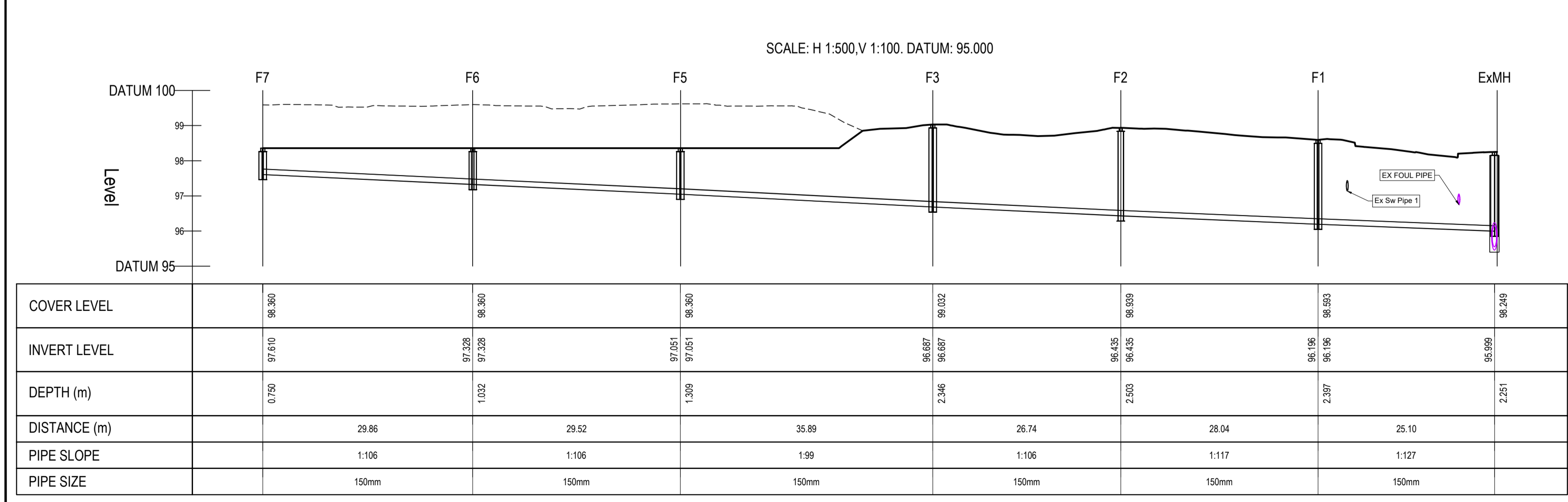

FOUL LONGSECTION

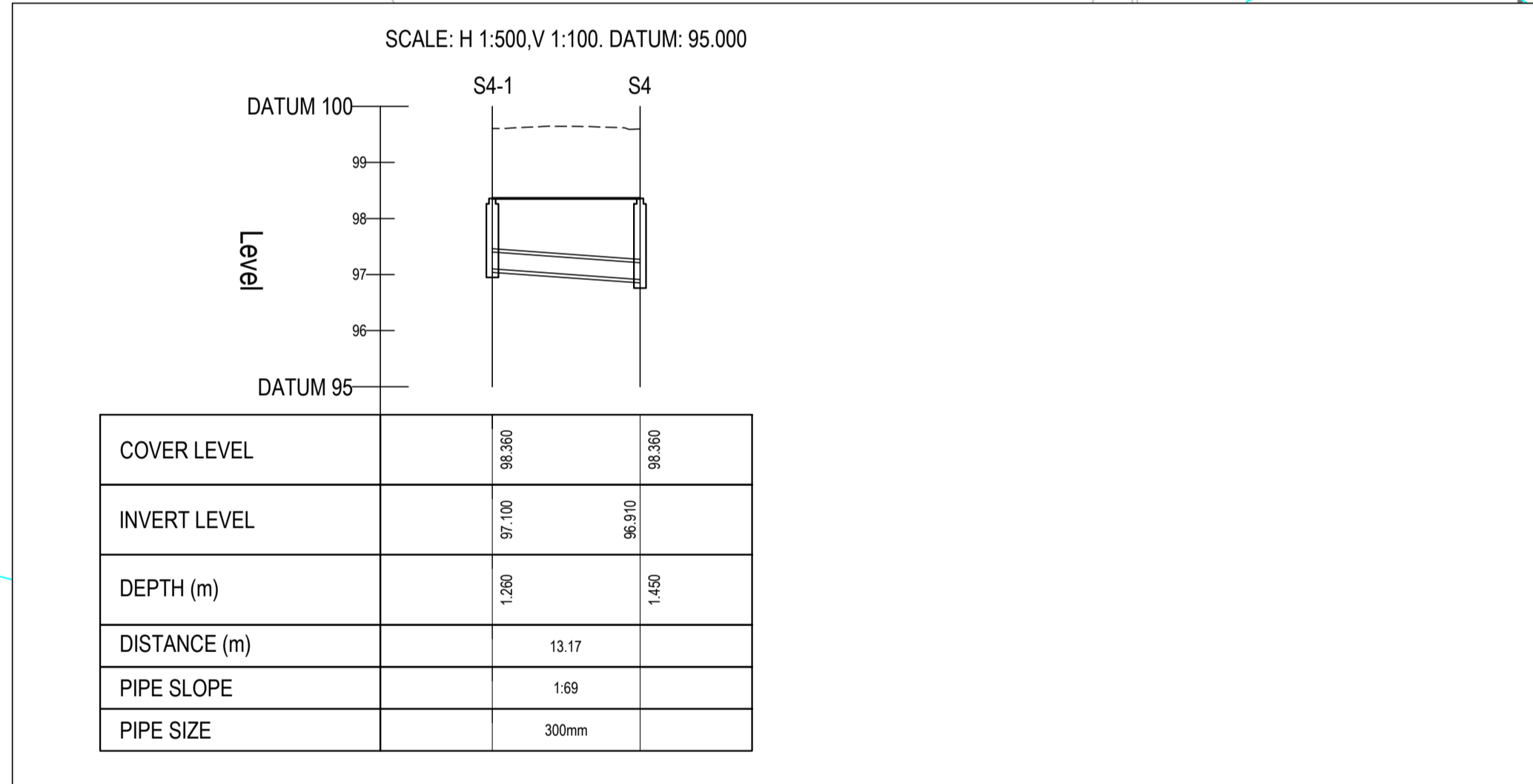
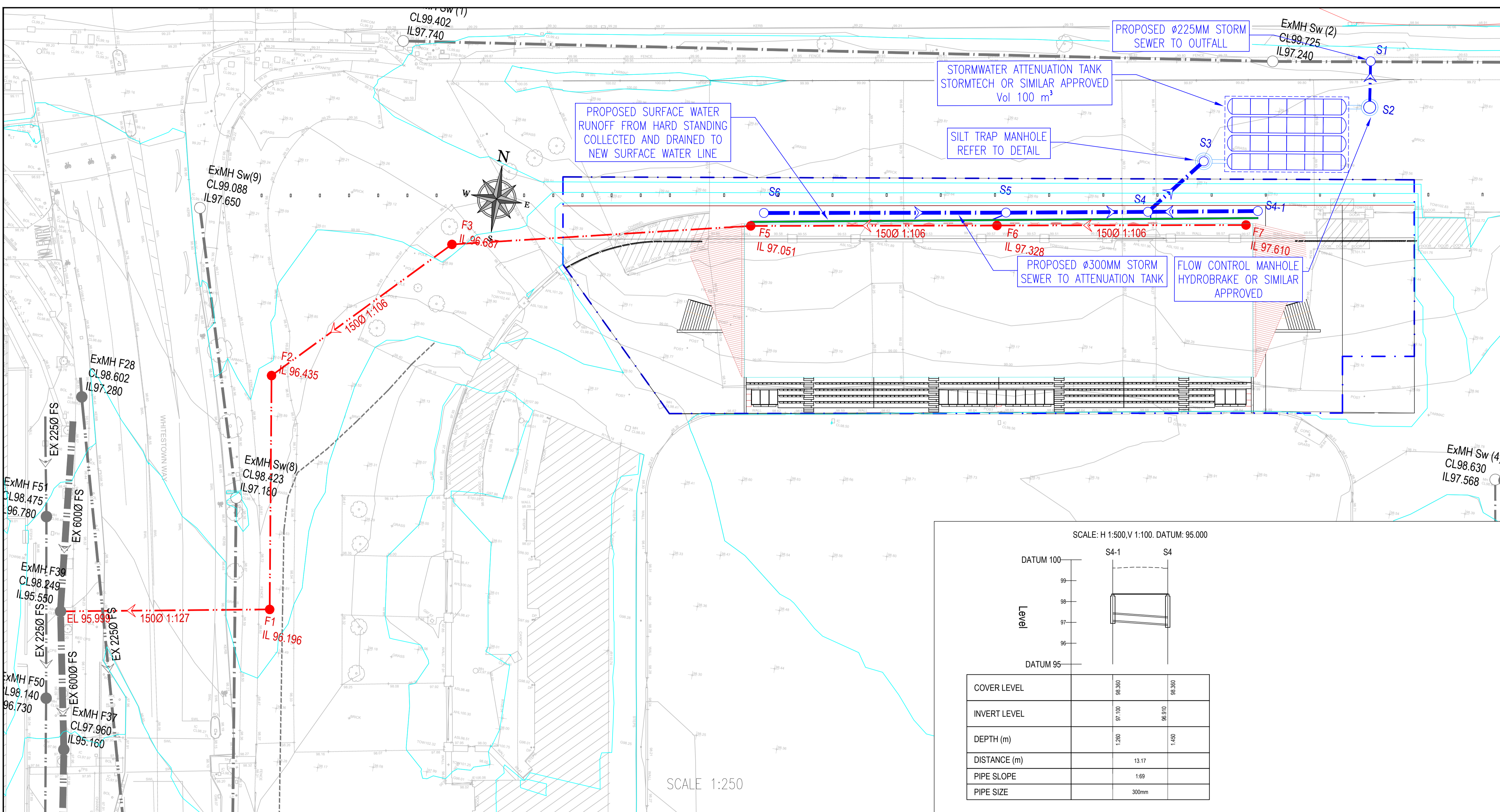
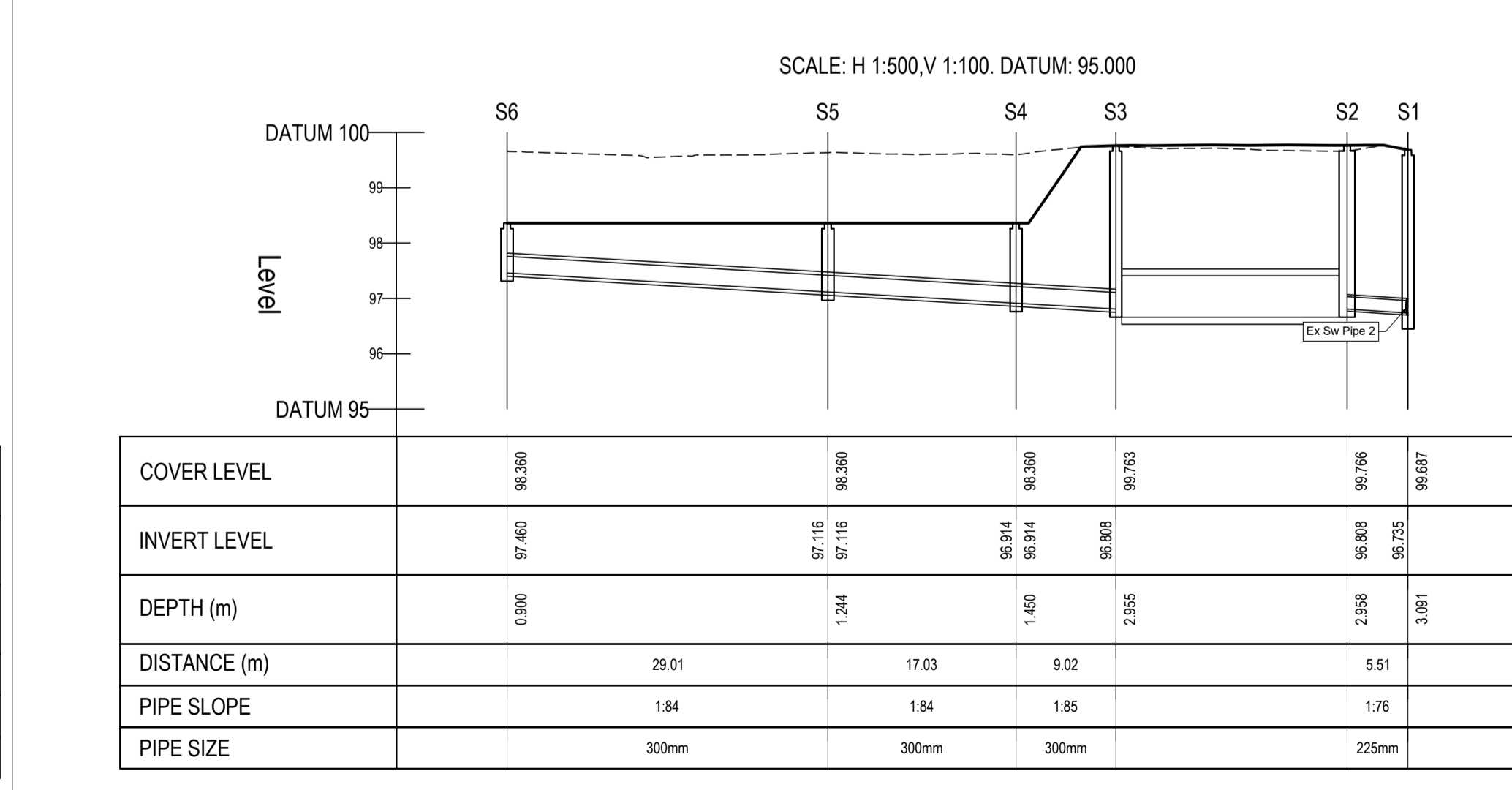

STORMWATER LONGSECTION

REV	DATE	DESCRIPTION	BY	CHKD
PLANNING				
DESIGNED	GIS	PREPARED	GIS	
DATE	29/06/20	CHECKED	NOH	

DBFL Dublin Office: Ormond House, Upper Ormond Quay, Dublin 7, Ireland. PHONE: +353 1 400 4000 FAX: +353 1 400 4050
 Waterford Office: Unit 2, The Chandlery, 1-2 O'Connell Street, Waterford, Ireland. PHONE: +353 51 308 500 FAX: +353 51 844 913
 DBFL Consulting Engineers email: info@dbfl.ie site: www.dbfl.ie

PROJECT
190179 - TALLAGHT STADIUM - NORTH STAND DEVELOPMENT

DRG. TITLE
PROPOSED DRAINAGE AND FOUL NETWORK

CLIENT
SOUTH DUBLIN CITY COUNCIL

SCALE AS NOTED @A1 FILE REF. 190179-DBFL-CS-XX-DR-C-1001
 DRG. NO. **190179-1001**