

Landscape plan 1:500 on A1 (CD16)

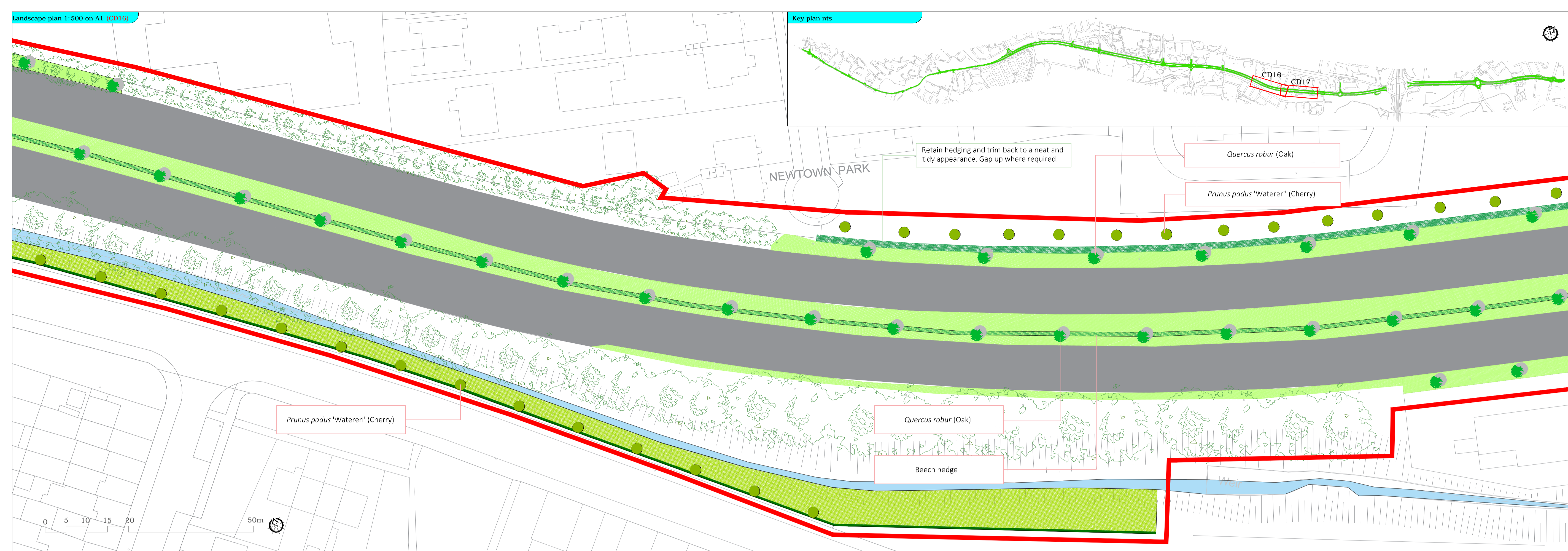

Key plan nts



Legend

- Trees**
  - Box headed *Quercus ilex*
  - Prunus padus* 'Watereri'
  - Acer campestre* 'Elsrijk'
  - Quercus robur*
  - Platanus x hispanica*
  - Sorbus aria*
  - Betula pendula* multi-stem
  - Zelkova serrata* 'Musashino'
  - Metasequoia glyptostroboides*
  - Crataegus monogyna*
  - Ulmus x hollandica* 'Commin'
  - Corylus colurna*
  - Sequoiadendron giganteum*
  - Castanea sativa*
  - Existing trees lifted and re-planted
  - Retained existing trees
  - Existing vegetation
- Planting**
  - Low maintenance ornamental shrub planting
  - Soft landscape planting
  - Lonicera pileata*
  - Viburnum tinus* 'Variegata'
  - Hedera hibernica*
  - Fagus sylvatica* Beech hedging
  - Grass
  - Reinforced grass
  - Bulbs
  - Fringe shrub mix
  - Hardy planting
  - Galvanised metal raised planters
- Hard landscaping**
  - Coloured tarmac/adam, beige
  - Large paving slabs
  - Precast textured permeable paving slabs
  - Concrete path
  - Indirect outdoor public lighting columns to be installed as part of public lighting upgrade
  - Cycle path
  - Cycle path N81 (Fortunestown to N82) upgrade scheme
  - New cycle path
  - Limestone setts
  - Decorative strip in pavement
  - Linear Strip lighting
  - Composite sinuous bench seating
  - Flag poles
  - Raised concrete planter, Lani range
  - Natural granite boulders
  - Concrete prisms
  - Stainless steel bollard
  - Green bus shelter
  - Site for sculpture
  - Feature lighting
  - Column light

Landscape plan 1:500 on A1 (CD17)



Speed limits for this section of roadway are under review by the South Dublin County Council

Rev	Date	By	Details
D	11/11/16	DB	Minor changes
C	04/11/16	DB	Minor changes
B	11/10/16	DB	Design
A	26/09/16	BV	Design

**AUSTEN ASSOCIATES**  
 One South House, South Quay, Wicklow Town, Co. Wicklow  
 M: 086 8057343 | T: 0454 66827  
 Email: design@austenassociates.ie | Web: www.austenassociates.ie  
 landscape architecture design project management  
 Copyright Austen Associates, 2016

Client: South Dublin County Council  
 Environment Water and Climate Change Department  
 Director: Teresa Walsh

Project title:  
**N81 Landscape corridor**

Drawing title:  
**Landscape Plan**

Drawn by: EOD Scale: 1:500 @ A1

Approved by: TA Date: May 2016

Status: Planning, Part VIII

Drawing no: 031016\_LP\_09 Revision: D