

General Notes:

- 1) This drawing is only to be used for the design element identified in the title box. All other information shown on the drawing is to be considered indicative only.
- 2) These drawings are to be read in conjunction with all other relevant design drawings.
- 3) All dimensions are in meters unless specified otherwise
- 4) Do not scale from drawing. Use Figured dimensions only.
- 5) All co-ordinates are to Irish Transverse Mercator (ITM).
- 6) All levels to Malin Head datum.

Plan Legend:

- Existing edge of pavement
- Proposed alignment
- Proposed fence line (LMA boundary)
- Proposed 125mm kerb
- Proposed dropped kerb
- Existing bus stop signs / poles
- Proposed bus stop signs / poles
- SMA red chip surfacing gateway treatment. "Type A Gateway", as per TII's DN-03084 & CC-SCD-05101
- New bus shelter
- Buff tactile blister paving (400x400mm)
- Red tactile blister paving (400x400mm)



Siohán Scully
 A/ DIRECTOR OF SERVICES
 Transport, Mobility & Open Spaces

Marie Whelan
 BEng (Hons) MSc CEng MIEI
 SENIOR ENGINEER

Suffix	Initials	Date	Description
D	MA	May 26	For Planning
C	MA	Mar. 26	For issue
B	MA	Mar. 26	For issue
A	MA	Jan. 26	For issue

REVISIONS

PROJECT N81 Brittas Village Traffic Calming & Urban Renewal Scheme
 Road Safety Improvement Scheme

DRAWING General Arrangement

Filename: N:\Projects\NRO23940 - Phase 3 ...
Dwg. No.: NRO239/0000/DR/302

1 of 2

Scale: 1:1000 @ A3
Date: May 26
Drawn by: MA
Checked: CJO
Revision D

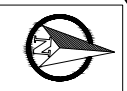

Brittas

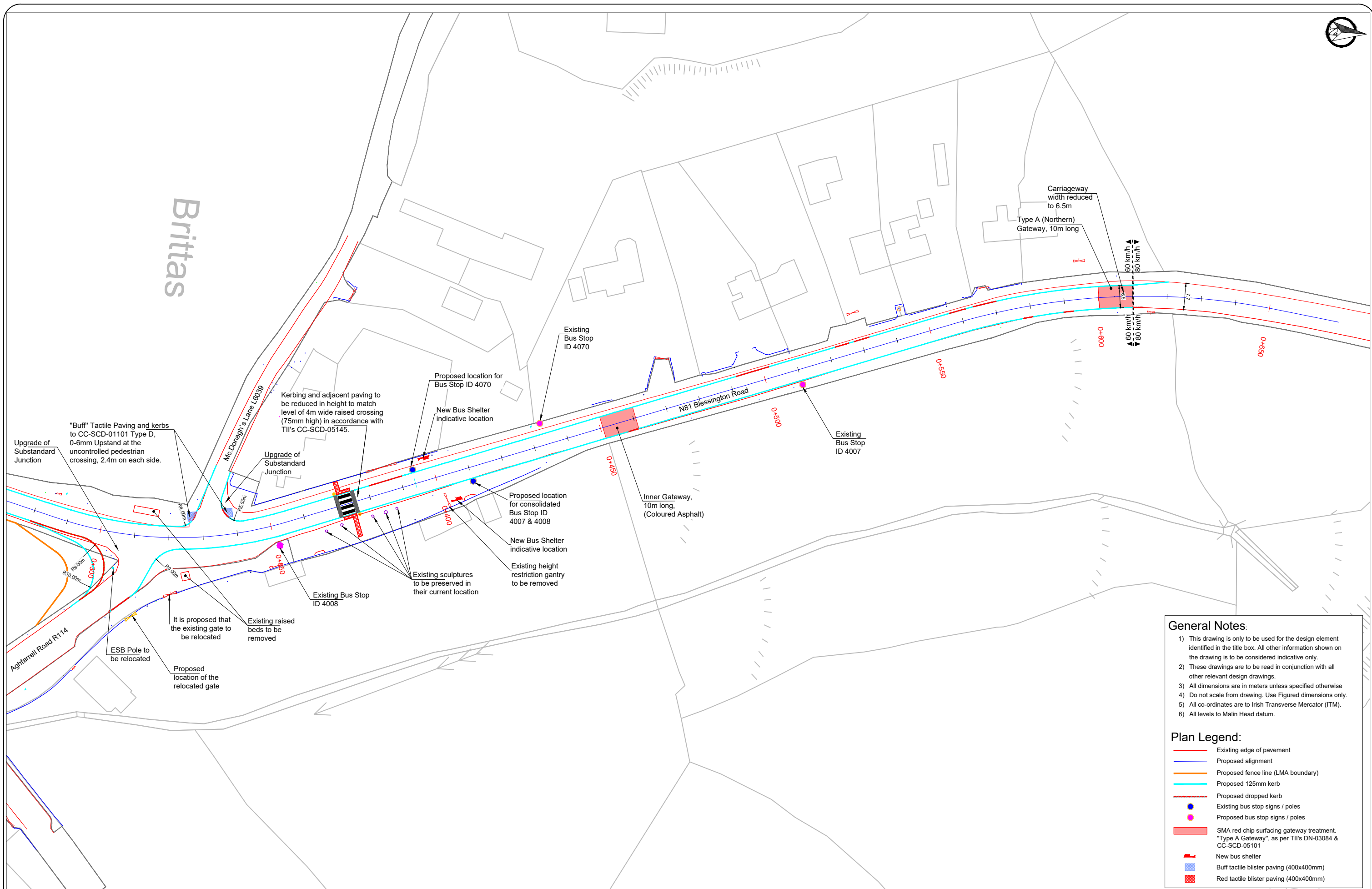

General Notes:

- 1) This drawing is only to be used for the design element identified in the title box. All other information shown on the drawing is to be considered indicative only.
- 2) These drawings are to be read in conjunction with all other relevant design drawings.
- 3) All dimensions are in meters unless specified otherwise.
- 4) Do not scale from drawing. Use Figured dimensions only.
- 5) All co-ordinates are to Irish Transverse Mercator (ITM).
- 6) All levels to Malin Head datum.

Plan Legend:

- Existing edge of pavement
- Proposed alignment
- Proposed fence line (LMA boundary)
- Proposed 125mm kerb
- Proposed dropped kerb
- Existing bus stop signs / poles
- Proposed bus stop signs / poles
- SMA red chip surfacing gateway treatment. "Type A Gateway", as per TII's DN-03084 & CC-SCD-05101
- New bus shelter
- Buff tactile blister paving (400x400mm)
- Red tactile blister paving (400x400mm)

TII
Bonneagar Iompair Éireann
Transport Infrastructure Ireland

KILDARE nro
NATIONAL ROADS OFFICE
Maudins, Naas, Co. Kildare, Ireland
Tel: +353-45-988900, Fax: +353-45-875845, e-mail: kcc@kildarenro.com

SDCC
Comhairle Contae South Dublin
Átha Cliath Theas County Council

Siohán Scully
A/ DIRECTOR OF SERVICES
Transport, Mobility & Open Spaces

Marie Whelan
BEng (Hons) MSc CEng MIEI
SENIOR ENGINEER

Suffix	Initials	Date	Description
D	MA	May 26	For Planning
C	MA	Mar. 26	For issue
B	MA	Mar. 26	For issue
A	MA	Jan. 26	For issue

REVISIONS

PROJECT N81 Brittas Village Traffic Calming & Urban Renewal Scheme
Road Safety Improvement Scheme

DRAWING General Arrangement

Filename: N:\Projects\NRO239\40 - Phase 3 ...
Dwg. No.: NRO239\0000\DR\302

2 of 2

Scale: 1:1000 @ A3

Date: May 26

Drawn by: MA

Checked: CJO

Revision
D