

Knocklyon to Ballyboden Active and Sustainable Travel Scheme - Part VIII

Outline

- Consultation Overview
- Project Background
- Cycle South Dublin Network
- Need for the Scheme
- Proposed Scheme:
 - Objectives
 - Key Features/Changes
 - Visualisations & Typical Cross Sections
 - Safe Route to School (SRTS)
St Colmcille's Senior JNS & SNS
 - Ballyboden Way
 - Roundabout Improvements
 - Visual Model of Proposed Scheme
- Have Your Say
- Next Steps

Please see the Part 8 Video via. Consultation Page

<https://consult.sdublincoco.ie/en/consultation/knocklyon-ballyboden-active-and-sustainable-travel-scheme>

Consultation Overview

Where: Knocklyon to Ballyboden - Firhouse Road, Knocklyon Road (including Gaelscoil Chnoc Liamhna), Idrone Avenue (including St. Colmcille's Junior and Senior National Schools), Dargle Wood Park, Templeroan Road (including Sancta Maria College)

What: The scheme focuses on improving the public realm and fostering a safer, more attractive environment for residents through traffic calming measures and neighbourhood enhancement, while also providing high-quality walking, cycling and public transport infrastructure. Reducing road widths is proven to be one of the most effective traffic calming measures to reduce traffic speeds as referenced in DMURS. The proposal includes reducing road widths, introducing new planting and trees, and implementing public realm interventions that enhance the character of the area. 4km of mainline improvements to include segregated cycle lanes with kerb protection will be provided along the majority of the scheme, existing shared surfaces will be utilised and on Knocklyon Road (outside SuperValu) and upgraded through Dargle Wood park. There are over 1.5km of secondary link improvements through residential roads comprising of small interventions such as the removal of kissing gates, raised entry treatment with continuous footpaths at side roads, creating new permeability links, new trees, grass planting and Safe Routes to School (SRTS) treatment. Proposals are subject to Detailed Design.

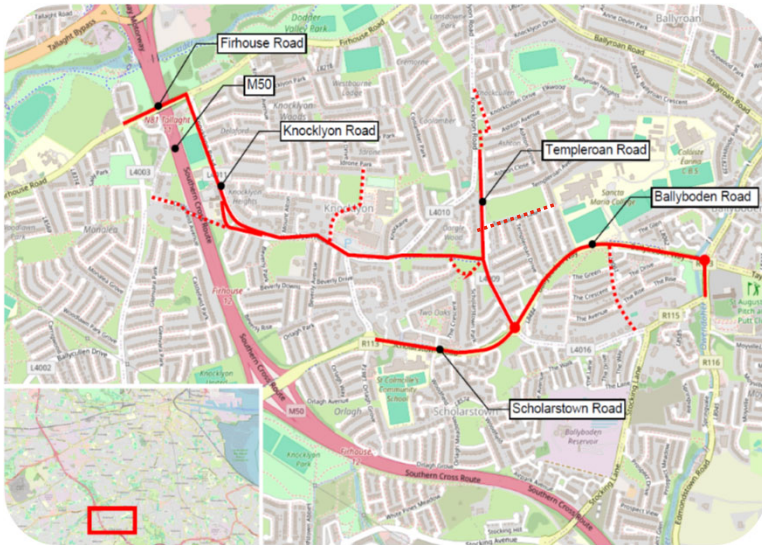

Consultation Overview

Why: The study area is currently served by generally low-quality walking and cycling infrastructure, unsafe crossings at roundabouts, high vehicular speeds along wide roads with large corner radii, high volume of vulnerable road users with local schools, community centres, etc., and delays to bus services on Ballyboden Way.

Reducing crossing distance for pedestrians and cyclists by upgrading the roundabouts and reducing corner radii at junctions will improve pedestrian and cyclist safety and improve connection and facilities for students and residents walking and cycling to local amenities. The revised lanes layout aims to improve access to bus services as well.



Existing



Proposed

Consultation Overview

How: Public Consultation as required by Part VIII, Article 81 of the Planning and Development Regulations 2001 (as amended). Drawings and details on how to make a submission on the consultation page:

<https://consult.sdublincoco.ie/en/consultation/knocklyon-ballyboden-active-and-sustainable-travel-scheme>.

When: Public consultation from 30th January and closes on 13th March at 5pm.



Project Background

2012: Part VIII Planning approval for 'Tallaght to Ballyboden Cycle Route'.

2023:

- Cycle Design Manual Released [updated Cycle Design Standards]
- Non statutory public consultation for 'Oldbawn to Ballyboden Active Travel Scheme Phase 1' - included part of this scheme. Decision to deliver Firhouse Road, Knocklyon Road, M50 pedestrian bridge and Idrone Avenue as part of Phase 2.
- Non statutory public consultation for 'Oldbawn to Ballyboden Active Travel Scheme Phase 2'

This Part 8 consultation – 'Knocklyon to Ballyboden Active and Sustainable Travel Scheme'

- Section 1: Firhouse Rd, Knocklyon Rd
- Section 2: Dargle Wood park, Templeroan Rd
- Section 3: Ballyboden Way, Ballyboden Rd
- Section 4: Scholarstown Rd

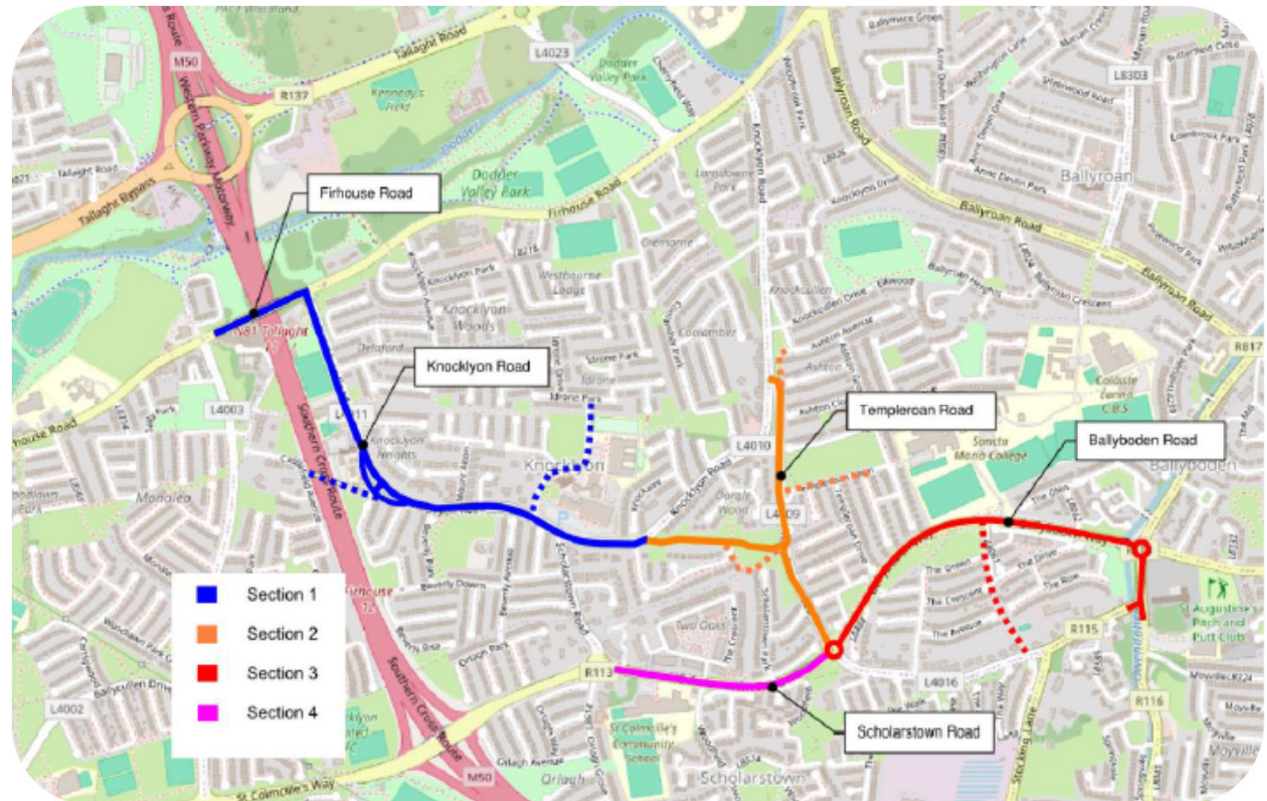

Proposed alignment for Knocklyon to Ballyboden Active and Sustainable Travel Scheme

Cycle South Dublin Network

This scheme falls into South Dublin County Council's ambitious Active Travel Network plan. In South Dublin County Council, we have a mission to make our county one of the most liveable, equitable, and sustainable in Ireland.

A pillar of this new mobility vision is Cycle South Dublin (an ambitious programme to deliver a connected network of high-quality walking and cycling improvements linking the places where people live to the places they want to go. There are 45 routes in the programme and the goal is to deliver over 250 km of safe walking and cycling improvements.

Knocklyon to Ballyboden Active and Sustainable Travel Scheme is part of this network and more information regarding the broader network can be found at <https://www.sdcc.ie/en/active-travel/>.

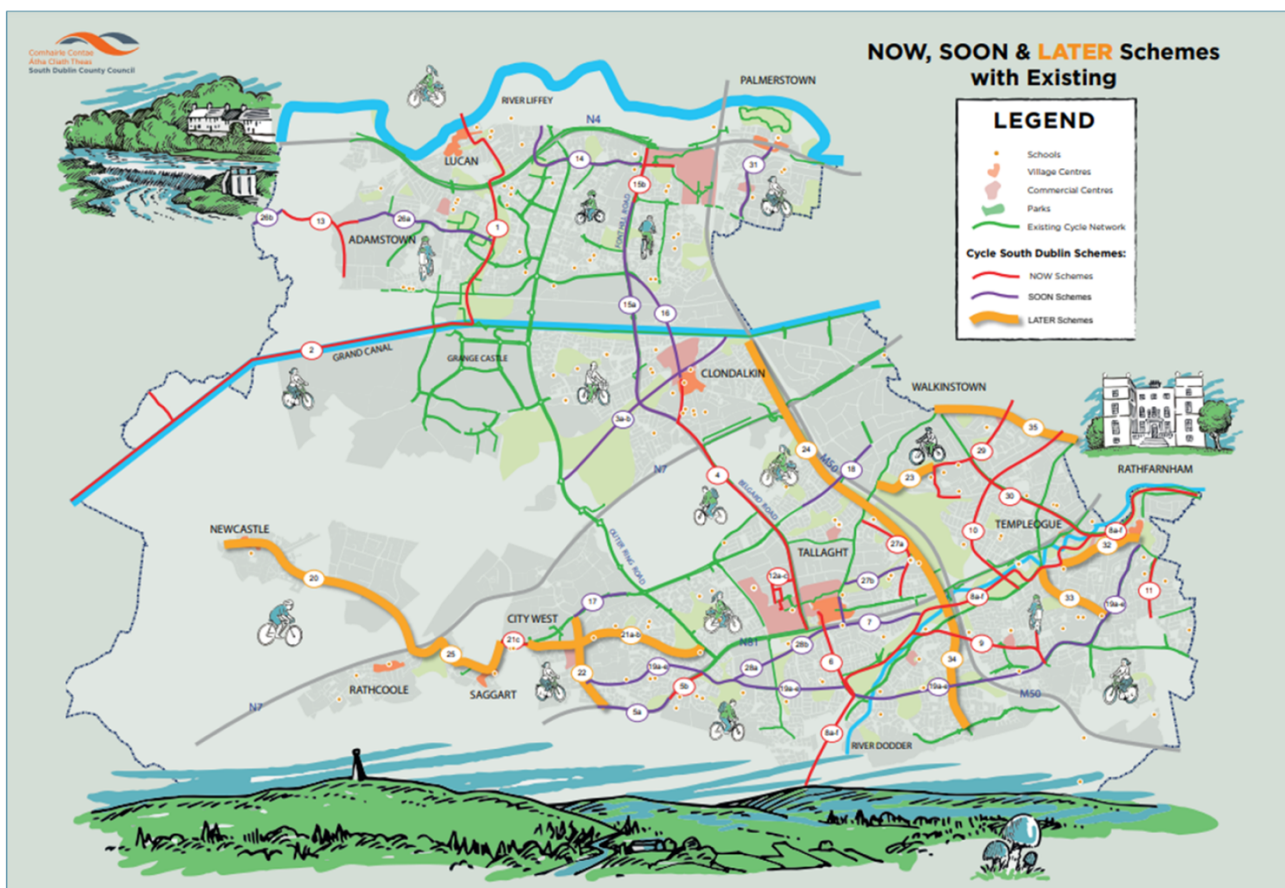

Need for the Scheme

Cycle South Dublin Programme: Part of the Active Travel network as adopted in Cycle South Dublin Programme.

Safety/Vulnerable road users: There are six educational facilities along, or within proximity of the Active Travel Scheme, along with several community centres and retail areas. The proposed Active Travel Scheme will provide continuous segregated walking and cycling infrastructure suitable for all ages and abilities along the full extent of the scheme. At uncontrolled junctions, pedestrian and cyclist priority will be provided; at signalised junctions kerb protected.

Existing carriageway geometry: Existing road along the route are excessively wide, not in alignment with current design standards, resulting in fast vehicular speeds. The side roads comprise of large corner radii and have no speed mitigation measures or pedestrian or cyclist priority.

Existing low-quality infrastructure: The study area is currently served by generally low-quality walking and cycling infrastructure with signalised junctions having no segregation for cyclists from motor vehicles. There are currently no cycling facilities along Knocklyon Road, Templeran Road and Scholarstown Road with limited facilities on Ballyboden Road.

The finished scheme will provide a safe, coherent and attractive route with a high Quality of Service that will form part of the wider strategic cycle network in the South Dublin area.



Existing



Proposed Scheme: Objectives

- Improve public realm and create a safer and more attractive environment for residents to walk and cycle by implementing traffic calming measures and neighbourhood enhancement.
- Improving the landscape along the route to improve biodiversity and create a more pleasant environment to walk and cycle.
- Installing safe school treatments outside schools.
- Make the area more accessible and liveable by improving pedestrian and cyclist accessibility by linking residential communities.
- Links to the wider active travel network in the county by enhancing walking, cycling and bus facilities.
- Speed reduction while maintaining capacity.

AXO SKETCH

A concept for the landscape design at Dargle Wood Park

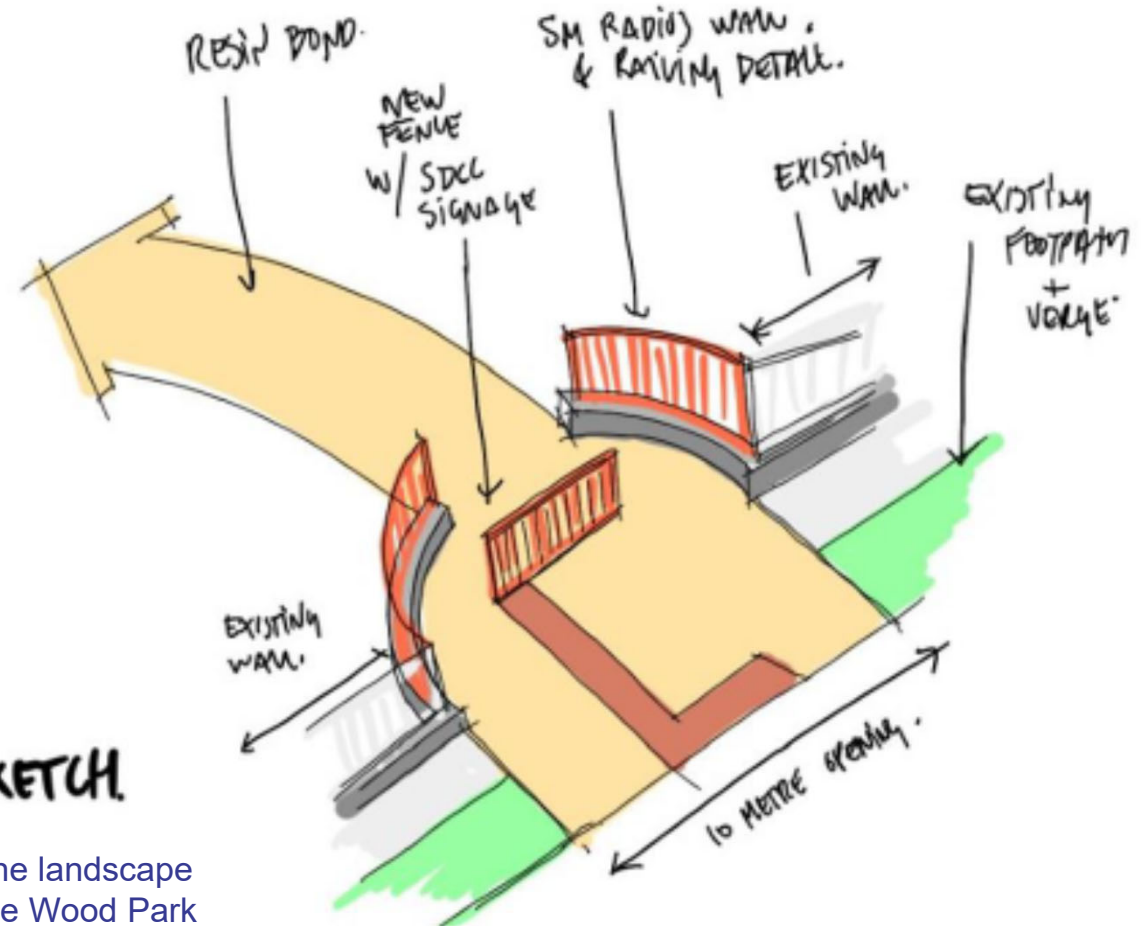

Proposed Scheme: Key Features/Changes

- Placemaking including access to laneway at M50 pedestrian bridge, and access to Dargle Wood park.
- 10 trees will be removed as a direct result of the proposed works, along with 20 trees due to disease. To compensate for the tree removal and enhance biodiversity in the area, 133 new trees will be planted along the route including at the path through Dargle Wood Park. Proposed net increase of 103 trees.
- Nature based Sustainable Drainage System at grassland adjacent to Knockcullen Rise.
- Traffic calming measures including reduced carriageway width and reduced corner radii with better visibility at crossings, roundabout improvements on Ballyboden Way.
- School improvements including Gaelscoil Chnoc Liamhna, St Colmcille's Junior and Senior National School, safer crossing at entrance to SuperValu Knocklyon (pending landowner agreement), Sancta Maria College
- Providing high quality walking, cycling including segregated cycle lanes with kerb protection will be provided along the majority of the scheme. Existing shared surfaces will be utilised on Knocklyon Road (outside Supervalu) and through Dargle Wood park.
- New of permeability links off Ballyboden Way to Boden Park The Lawn and Templeroan Green.
- Providing bus stop shelters throughout scheme where possible and new bus lane on Ballyboden Way. Propose 15b will stop at S8 bus stops No. 7974 and 7909, and removal of bus stop No. 7442.
- Over 1.5km of secondary link improvements through residential roads comprising of small interventions such as the removal of kissing gates, raised entry treatment with continuous footpaths at side roads.

*Proposals are subject to Detailed Design.

Proposed Scheme: Knocklyon Road

Existing



Artist's Impression of proposal



Proposed Scheme: Gaelscoil Chnoc Liamhna

Existing



Artist's Impression of proposal



Proposed Scheme: Templeroan Road

Existing



Artist's Impression of proposal



Proposed Scheme: Ballyboden Way

(adjacent to Templeroan Drive)

Existing



Computer generated visualisation of proposal



Proposed Scheme: Scholarstown Road

Existing



Artist's Impression of proposal



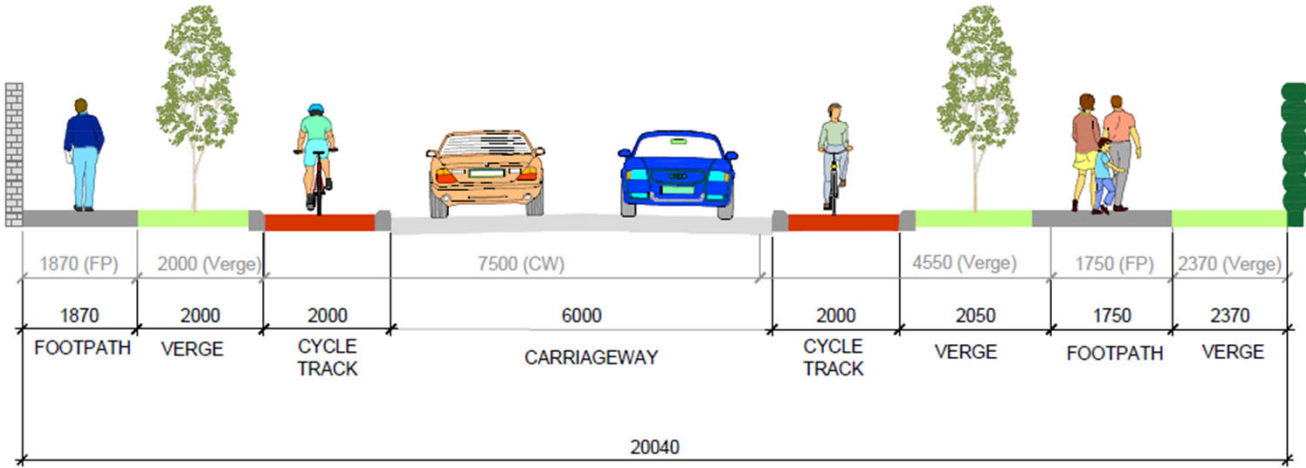

Typical Cross Section proposed on Knocklyon Road

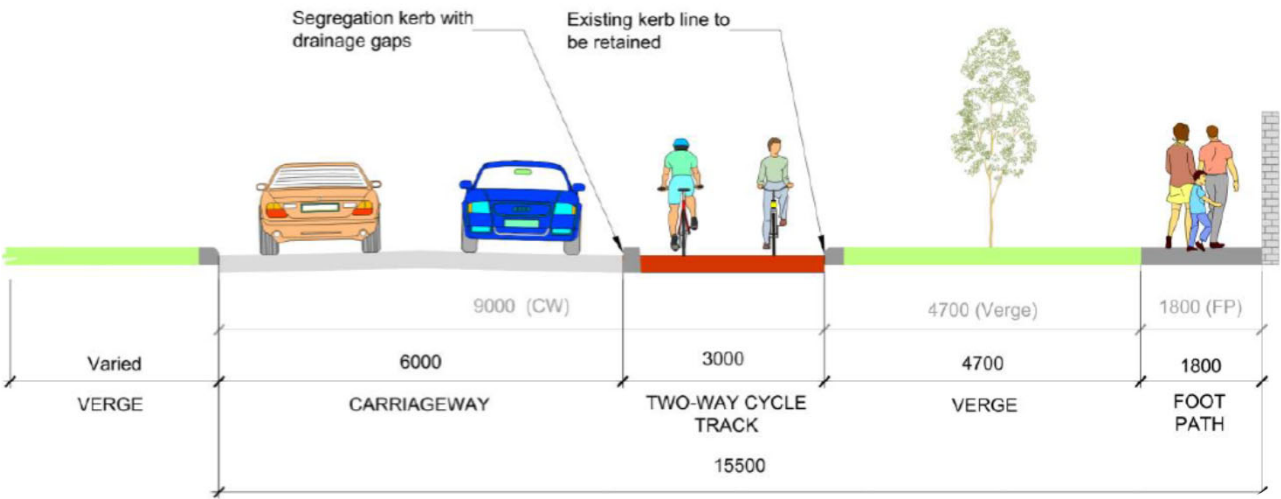

Typical Cross Section proposed on Templeroan Road

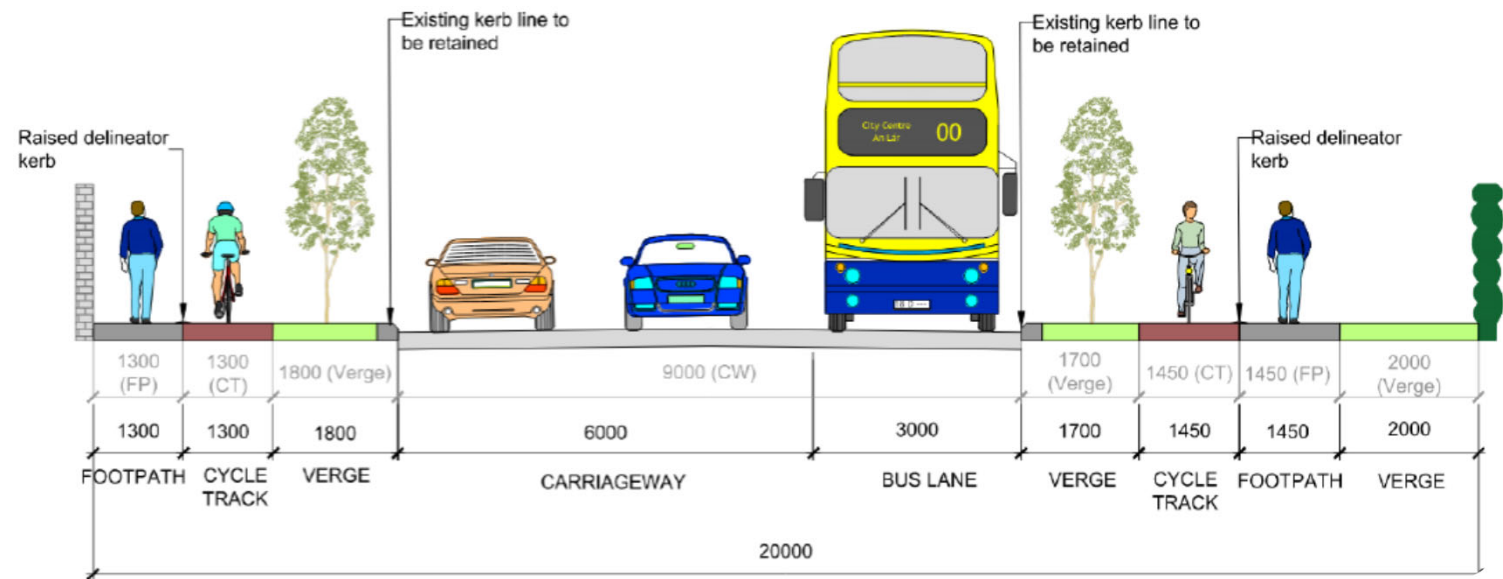

Typical Cross Section proposed on Ballyboden Way

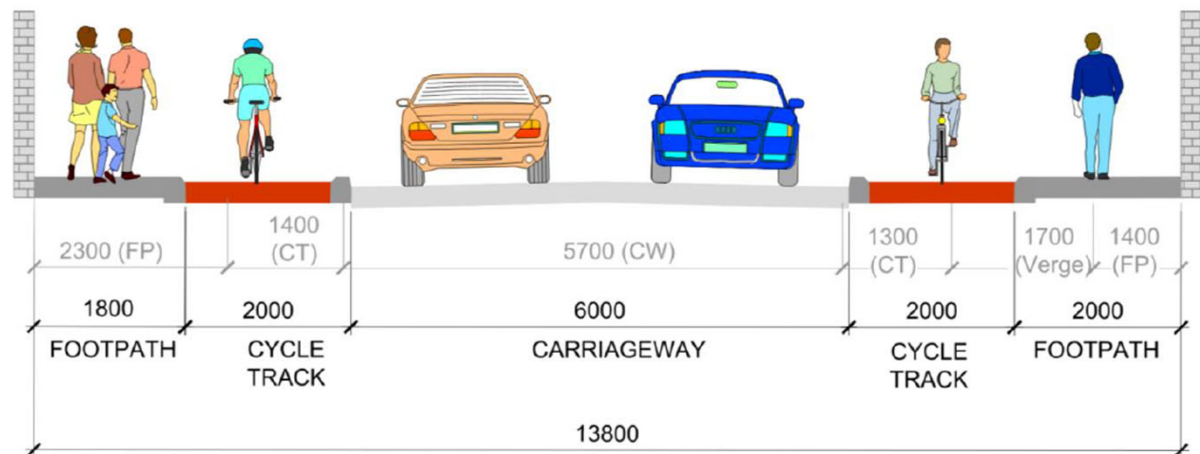

Typical Cross Section proposed on Ballyboden Road

Proposed Scheme: Safe Route to School (SRTS)

St Colmcille's Senior National School

This Active Travel scheme includes SRTS St Colmcille's Senior National School. South Dublin County Council have worked in conjunction with SRTS, An Taisce and the schools to carry out surveys and studies to develop the proposal. This school has high proportion of active travel, and this scheme seeks to make significant improvement to maintain and enhance active travel in the environs of the school.

Bike Week Podcast was recorded at St. Colmcille's SNS in May 2025 with some of their students explaining why cycling means so much to them

<https://www.rte.ie/radio/podcasts/22510987-ep-88-hop-on-for-bike-week/>

Benefits of walking and cycling:

- Physical and mental health
- Social/Leisure
- Environmental / carbon emission reduction
- Transport mode / reduction in vehicular traffic

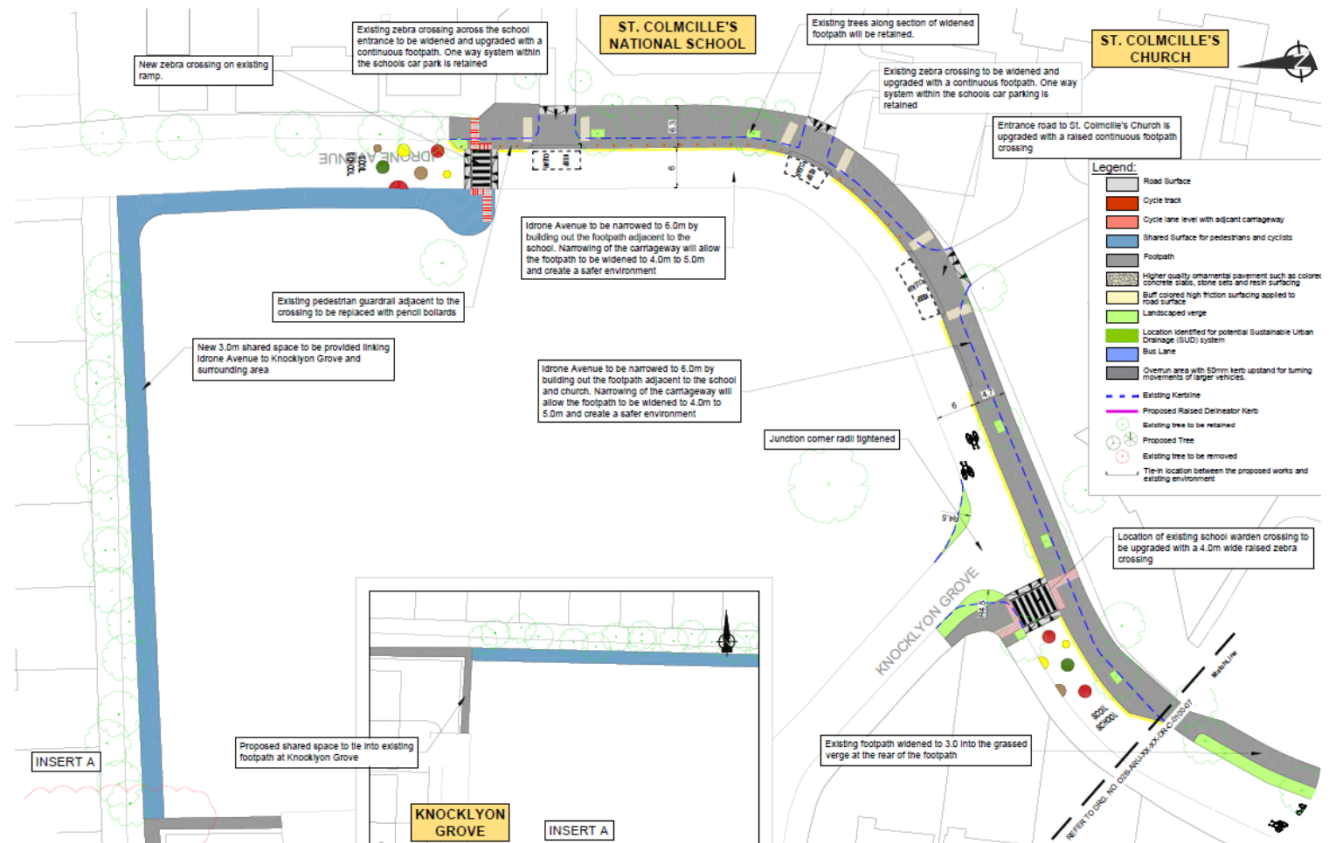

Proposed Scheme: Ballyboden Way

The previous consultation presented options for cycle lanes on Ballyboden Way. Since then, delays to bus services have been experienced along Ballyboden Way which has led to a need for bus provision.

The revised proposal scheme will now be configured using existing cycle tracks with the addition of proposed bus lanes. Any necessary maintenance will be carried out to existing footpath and cycle lanes.

A new pedestrian crossing is proposed where the proposed bus lane flips from eastbound to westbound. This will allow safe access to bus stops on both sides as well as inclusion of permeability links. At this location, one bus stop will be relocated 15m away and new bus shelters are proposed.

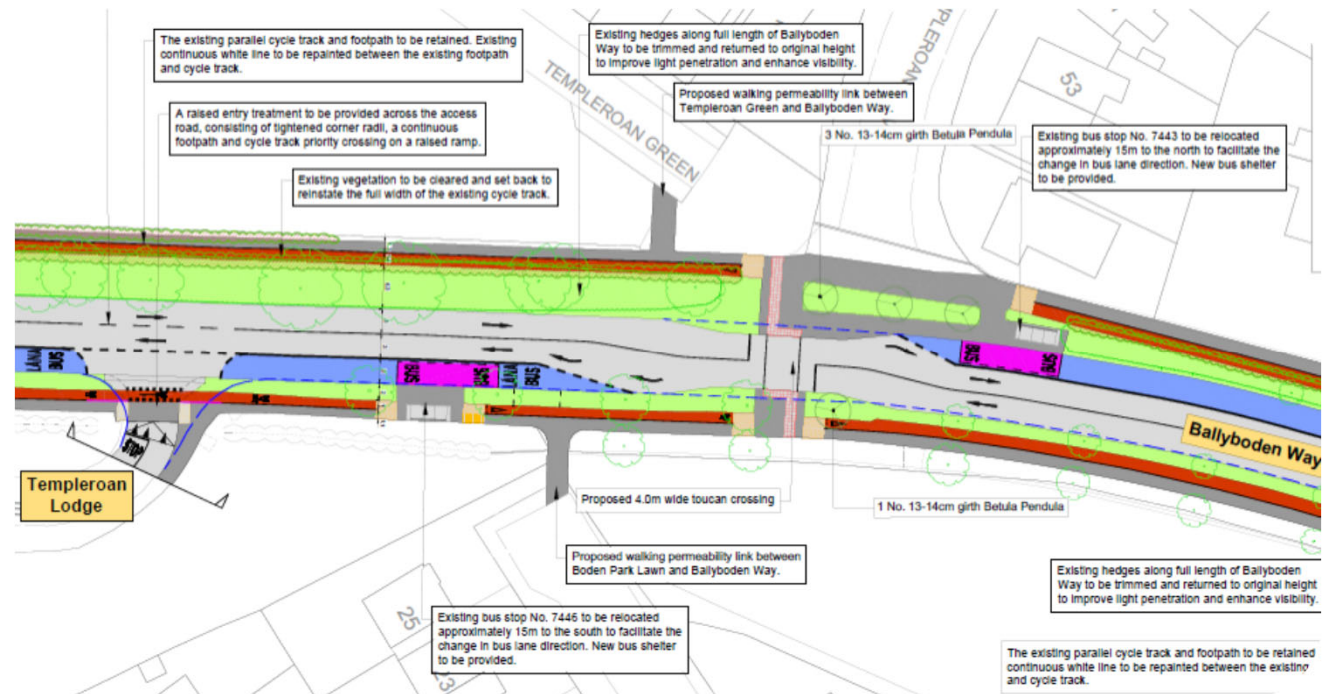

Proposed Scheme: Roundabout Improvements

The scheme includes upgrades at the two roundabouts on Ballyboden Way, at Taylors Lane and Templeroan Road. This is required as the roundabouts do not provide safe crossings for vulnerable road users.

The proposed protected roundabouts provide full segregation between vulnerable road users and vehicular traffic. Motorists are provided with improved visibility of pedestrians and cyclists using the zebra crossings.

These roundabouts cater for the anticipated volumes of traffic as outlined in the traffic modelling report of the Old Bawn to Ballyboden Phase 2 non statutory public consultation.

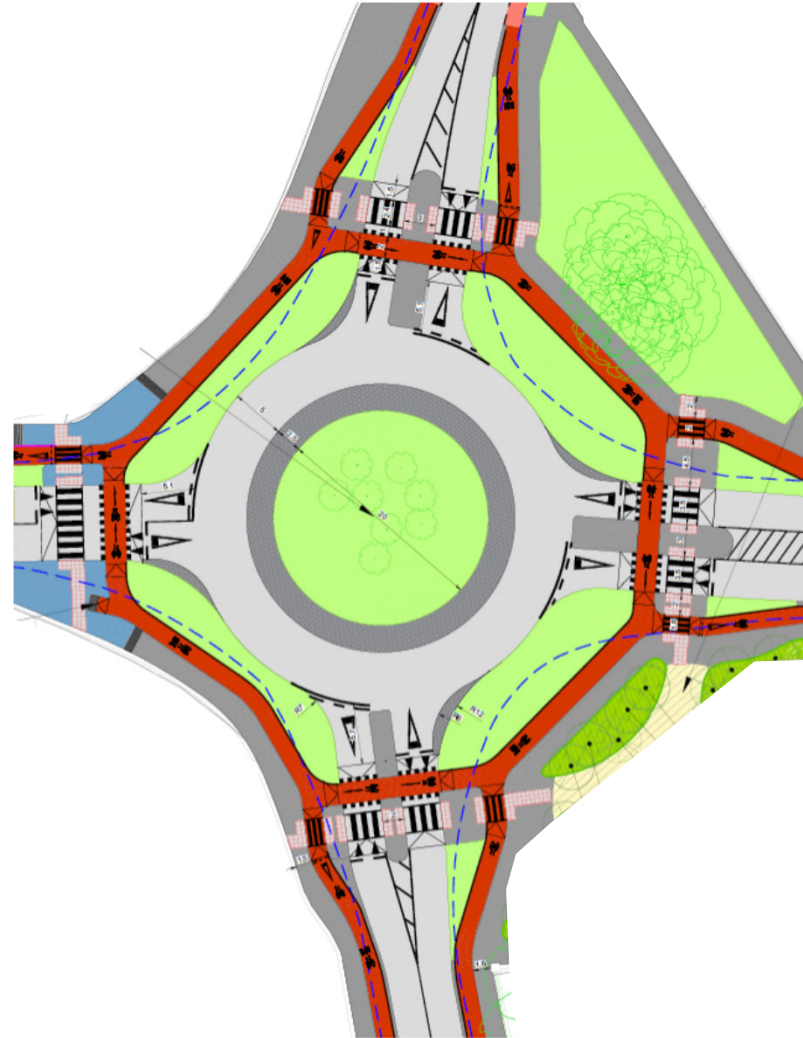

Visual Model of Proposed Scheme (Ballyboden Way)

In order to assist the public's understanding of the changes, a 3D computer model has been created to represent the proposals along Ballyboden Way, including the two roundabouts either side. This will provide realistic imagery as part of the consultation material.

Councillors will be given the opportunity to experience this computer model in a virtual reality setting, at the beginning of the consultation period.

A link to a video demonstrating the user's experience of pedestrian, cyclist, and private car driver is available on the consultation page.



Have Your Say

Statutory public consultation is occurring as part of the Part VIII, Article 81 of the Planning and Development Regulations 2001 (as amended).

Please visit

<https://consult.sdublincoco.ie/en/consultation/knocklyon-ballyboden-active-and-sustainable-travel-scheme> for more information and to submit an observation on Knocklyon to Ballyboden Active and Sustainable Travel Scheme.

The consultation closes on 13th March 2026 at 5pm.



Next Steps

Refer to Part 8 Video via. Consultation Page

<https://consult.sdublincoco.ie/en/consultation/knocklyon-ballyboden-active-and-sustainable-travel-scheme>

After Part VIII consultation period closes, the SDCC Active Travel team will read and consider all the submissions. A report will be presented to the South Dublin County Councillors. This report contains, amongst other items, a list of the persons or bodies who made submissions, along with a summary of the issues raised by them and the Chief Executive's response.

Following consideration of the report, the scheme may be carried out as recommended in the report, or the Councillors, by resolution may decide to vary, modify or not proceed with the proposed scheme.

If a decision is made to proceed with the scheme, it will progress to Detailed Design, followed by construction, subject to funding.



Comhairle Contae
Átha Cliath Theas

South Dublin
County Council

Thank you

© SDCC
Comhairle Contae Átha Cliath Theas
South Dublin County Council

For more information
please contact:

T 01 4149000
E info@sdublincoco.ie