

Ballyroan Parish

8th May 2025

South Dublin County Council,  
County Hall Tallaght,  
Dublin 24,  
D24 A3XC

**WITHOUT PREJUDICE  
SUBJECT TO CONTRACT/CONTRACT DENIED**

Dear Sir/Madam

**Proposed Works:**

I wish to confirm that Ballyroan Parish hereby grants its consent to South Dublin County Council to submit a Part 8 planning application in respect of the proposed extension and upgrade works to the existing Ballyroan Community and Youth Centre on land in the ownership of Ballyroan Parish, as outlined in red on the attached site layout map.

This consent does not convey to the Applicant any interest whatsoever in the land and is for the sole purpose of allowing a Part 8 planning application to be submitted and the associated public consultation process to proceed.



Yours sincerely,

Michael Muntagh P.P. Ballyroan

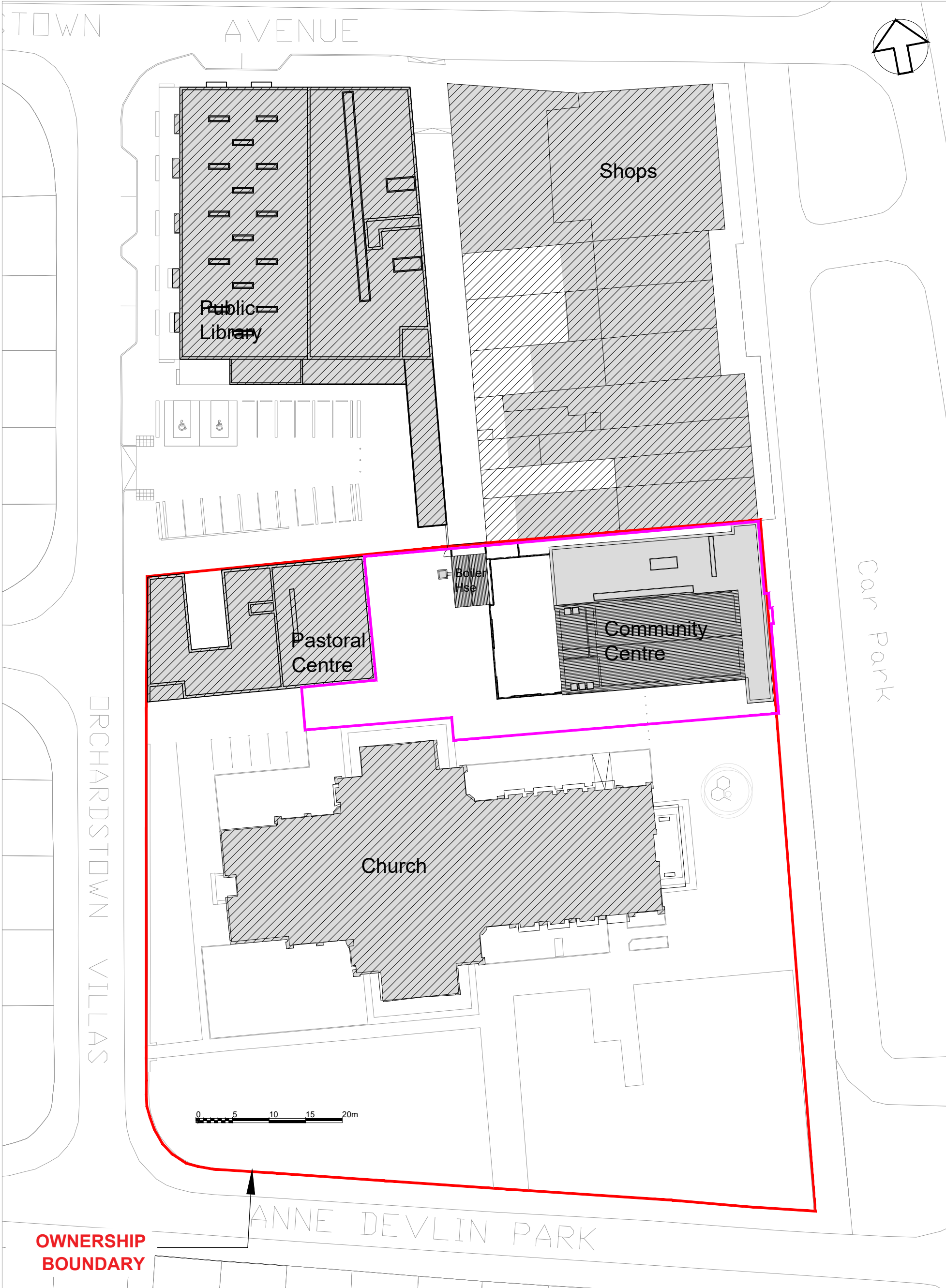
Encl. Site Layout Map No. 2304CO\_SK\_001A



South Dublin County Council Comhairle Chontae Atha Cliath Theas
Co. Dublin O.S. Sheet No. 3391-07
Scale 1:1000
Drawing Number 2304CO_SK_001A
This map is certified to be computer generated by South Dublin County Council from Ordnance Survey Digital Map Base

-  OWNERSHIP /SITE BOUNDARY (BALLYROAN PARISH)
-  PROPOSED DEVELOPMENT AREA / SITE BOUNDARY (PART 8)