



Director:  
**Michael McAdam**

Senior Engineer:  
**John Hegarty**

LEGEND:

Foul Sewer		Red
Surface Water Sewer		Green
Watermain		Blue
Fire Hydrant		Sluice Valve
Air Valve		Scour Valve
Foul Water Not for TIC		Grey
Surface Water Not for TIC		Grey
Site Boundary		Red

Open Space	
Roads and Footpaths to be TIC	
Wayleaves	

0 40 80 Meters

Revision	Description	Date

Notes:  
This drawing does not constitute a recommendation to have an estate taken in charge.  
This drawing refers to the taking in charge of the roads and services as indicated in colour.  
All sewers are 225mm dia. unless otherwise indicated.  
Scaled dimensions not to be used.  
Length of roads as on attached road schedule.  
Boundary treatments to roads taken in charge i.e. walls and/or railings are not included in, and are not part of the taking in charge procedure.

Location:  
**HALLWELL  
ADAMSTOWN  
LUCAN  
CO. DUBLIN**

Drawing Title:  
**Taking in Charge Drawing**

Drawn by: <b>PL</b>	O.S. Reference: <b>3260 A, 3260-8</b>
Surveyed by: <b>IS</b>	Scale: <b>1:1000</b>
Checked:	Date: <b>06/11/2024</b>

Drawing Number:  
**BC 1475**

Foul Sewer					
Manhole No	Cover Level	Invert Level	Backstop	Pipe Size	Noting
F1	46.757	45.307	n/a	225mm	F0152.964 F34001.368
F12	45.999	45.399	n/a	225mm	F0149.750 F34005.269
F13	45.839	45.059	n/a	225mm	F01536.169 F34018.473
F14	46.466	44.916	n/a	225mm	F01532.623 F34009.197
F15	45.467	43.967	n/a	225mm	F01581.976 F34100.166
F16	44.964	43.434	n/a	225mm	F01565.741 F34135.049
F17	44.163	42.763	n/a	225mm	F01629.290 F34165.829
F18	44.157	42.067	n/a	225mm	F01625.776 F34175.848
F19	46.795	45.165	n/a	225mm	F01456.451 F34027.169
F110	46.015	44.705	n/a	225mm	F01426.114 F34090.879
F111	46.427	44.397	n/a	225mm	F01491.540 F34144.825
F112	46.242	44.792	n/a	225mm	F01513.440 F34077.414
F113	46.073	44.623	n/a	225mm	F01503.280 F34099.183
F114	46.203	44.273	n/a	225mm	F01478.353 F34150.035
F115	45.966	43.986	n/a	225mm	F01450.112 F34181.443
F116	45.771	43.871	n/a	225mm	F01468.750 F34198.601
F117	45.511	43.671	n/a	225mm	F01482.154 F34215.556
F118	45.210	43.310	n/a	225mm	F01532.462 F34204.733
F119	45.243	43.793	n/a	225mm	F01546.860 F34177.412
F120	45.273	43.513	n/a	225mm	F01504.940 F34225.224
F121	45.054	43.284	n/a	225mm	F01512.360 F34248.468
F122	44.375	42.945	n/a	225mm	F01585.583 F34280.472
F123	44.272	42.832	n/a	225mm	F01593.791 F34278.240
F124	44.000	42.520	n/a	225mm	F01631.734 F34237.277
F125	43.846	42.356	n/a	225mm	F01612.241 F34222.318
F126	43.270	40.270	41.170	225mm	F01646.730 F34182.768
F127	41.466	38.716	n/a	225mm	F01666.030 F34198.245

Trunk Sewer Levels		
MH No	Cover Level	Invert Level
F1	38.602	39.367
F2	45.892	39.624
F2.4	38.983	34.383
F3	42.184	38.599
F4	40.722	37.262
F5	39.363	34.444
F6	37.878	33.656
F13	45.728	40.704
F18	45.826	39.400
F18B	45.846	40.307
F76	45.813	40.968

SURFACE WATER SEWER		
MH No	Cover Level	Invert Level
S2	45.900	38.121
S3	42.764	37.624
S4	41.275	37.307
S5	39.447	33.470
S6	37.739	33.267
S9	45.500	39.601
S9A	45.890	41.335
S10	45.809	38.271
S100	45.709	40.821

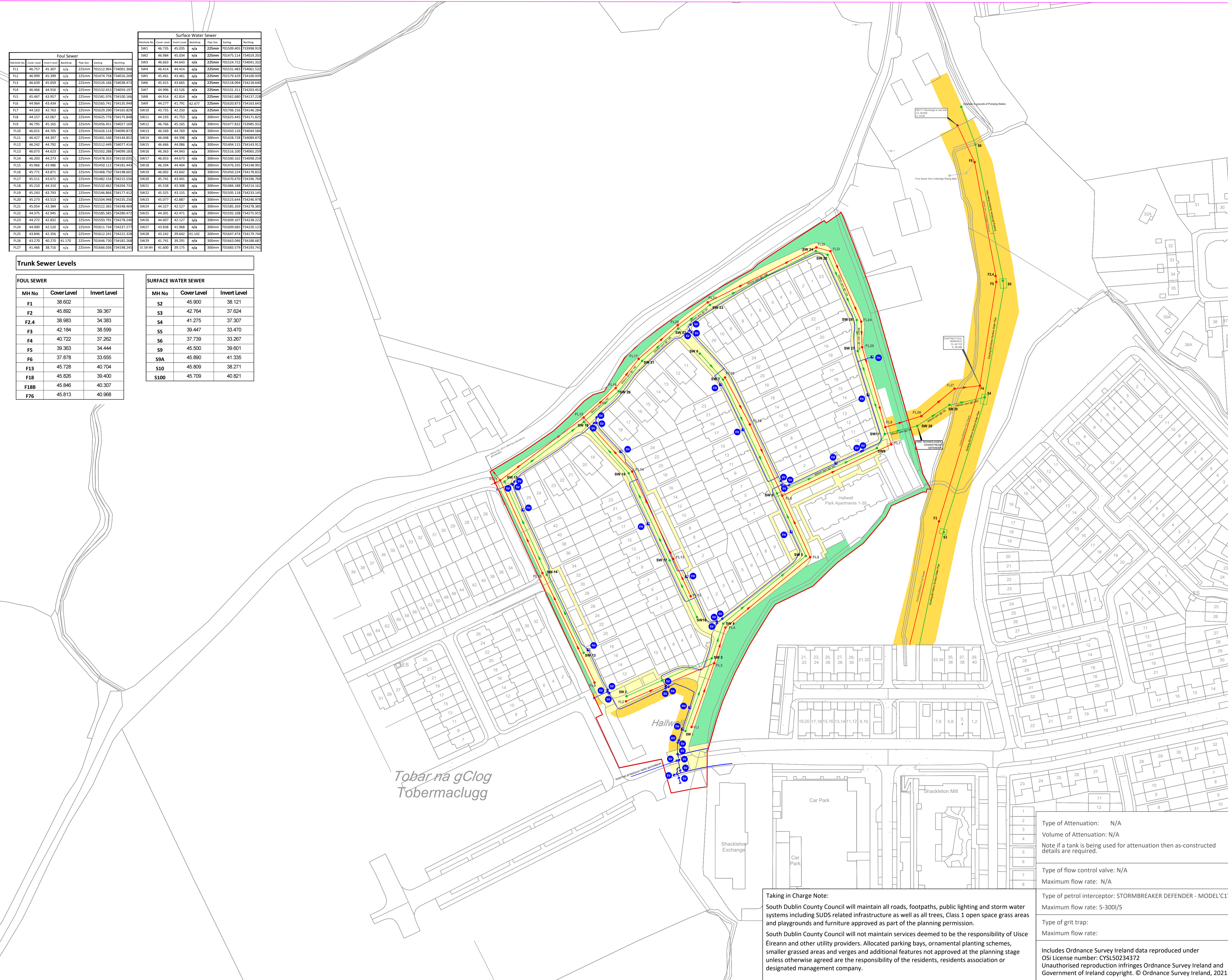

**Taking in Charge Note:**  
South Dublin County Council will maintain all roads, footpaths, public lighting and storm water systems including SUDS related infrastructure as well as all trees, Class 1 open space grass areas and playgrounds and furniture approved as part of the planning permission.  
South Dublin County Council will not maintain services deemed to be the responsibility of Uisce Éireann and other utility providers. Allocated parking bays, ornamental planting schemes, smaller grassed areas and verges and additional features not approved at the planning stage unless otherwise agreed are the responsibility of the residents, residents association or designated management company.

Type of Attenuation:	N/A
Volume of Attenuation:	N/A
Note if a tank is being used for attenuation then as-constructed details are required.	
Type of flow control valve:	N/A
Maximum flow rate:	N/A
Type of petrol interceptor:	STORMBREAKER DEFENDER - MODEL 'C1'
Maximum flow rate:	5-300l/s
Type of grit trap:	
Maximum flow rate:	
Includes Ordnance Survey Ireland data reproduced under OSI License number: CYSL50234372 Unauthorised reproduction infringes Ordnance Survey Ireland and Government of Ireland copyright. © Ordnance Survey Ireland, 2021.	