

NO PART OF THIS DRAWING MAY BE REPRODUCED OR TRANSMITTED IN ANY FORM OR STORED IN ANY RETRIEVAL SYSTEM OF ANY NATURE WITHOUT THE WRITTEN PERMISSION OF MALONE O'REGAN CONSULTING ENGINEERS AS COPYRIGHT HOLDER EXCEPT AS AGREED FOR USE ON THE PROJECT FOR WHICH THE DRAWING WAS ORIGINALLY CREATED.

THIS DRAWING TO BE READ IN CONJUNCTION WITH ALL OTHER RELEVANT DRAWINGS, SPECIFICATIONS AND THE PRELIMINARY HEALTH & SAFETY PLAN.

ALL DIMENSIONS ARE IN mm UNLESS NOTED OTHERWISE. DO NOT SCALE DIMENSIONS.

THE CONTRACTOR SHALL CHECK ALL DIMENSIONS PRIOR TO THE COMMENCEMENT OF CONSTRUCTION. ALL DISCREPANCIES SHALL BE REPORTED TO THIS OFFICE IN WRITING.

NOTES



FOOTPATH CONSTRUCTION
100mm GRADE C32/40 CONCRETE WITH 1 LAYER A142 MESH ON 200mm CLAUSE 808 HARDCORE

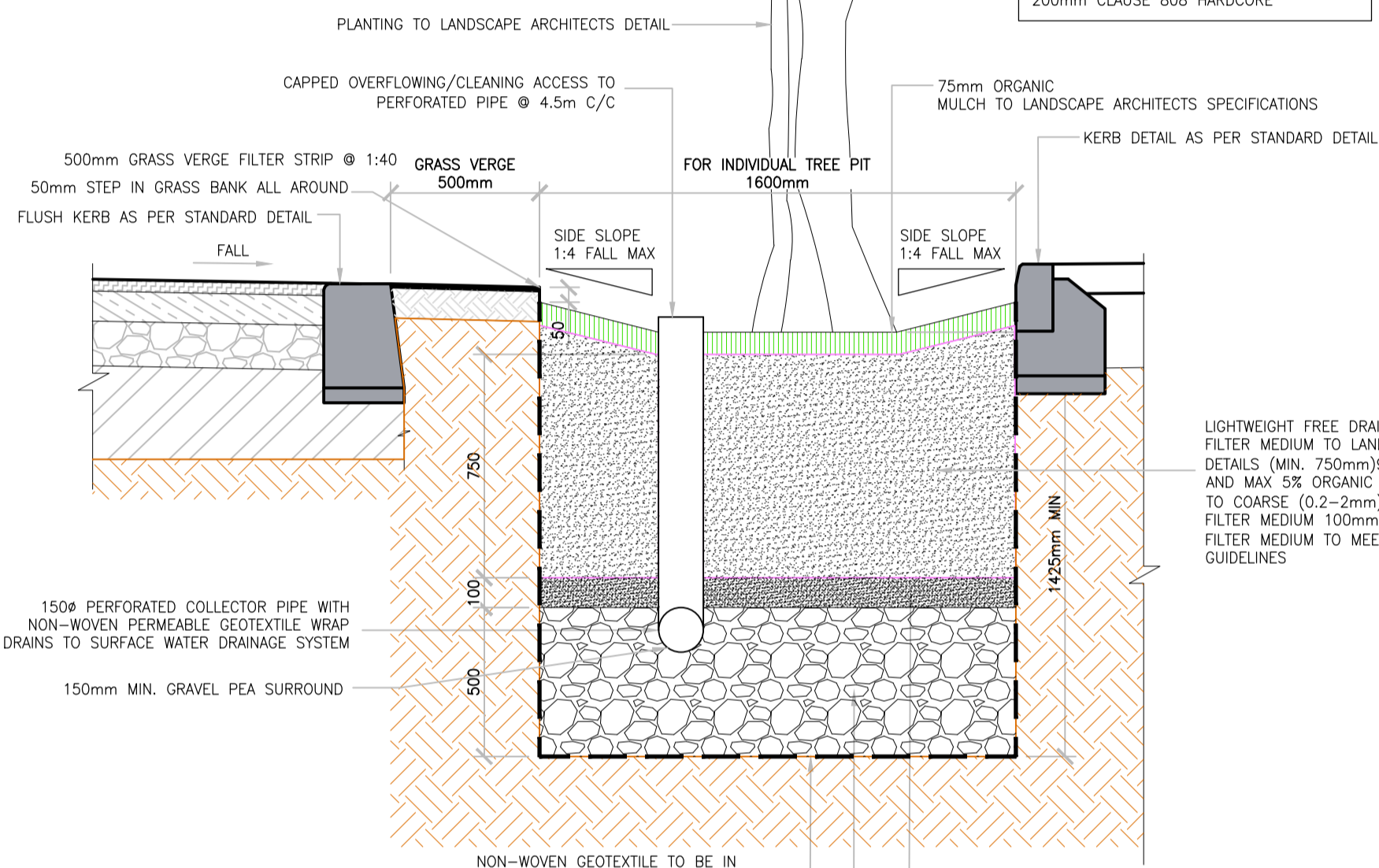

TREE PIT DETAIL
SCALE 1:20

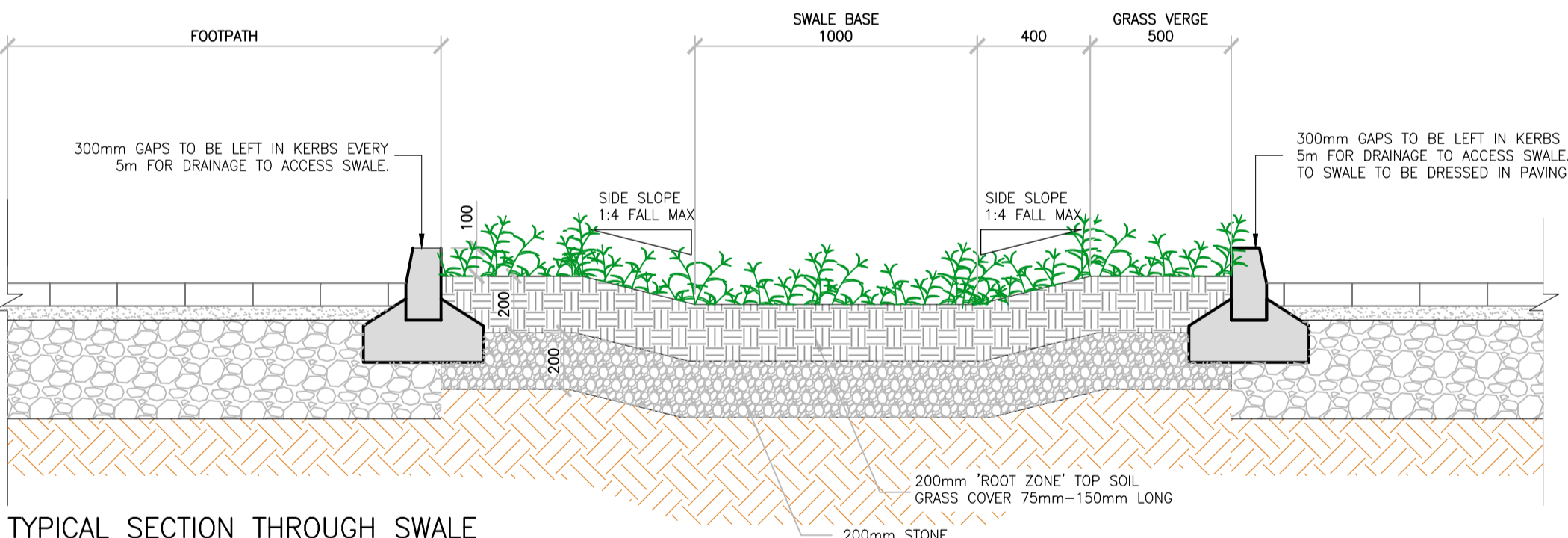

TYPICAL SECTION THROUGH SWALE TAKING DRAINAGE FROM A HARDSTANDING AREA
SCALE 1:20

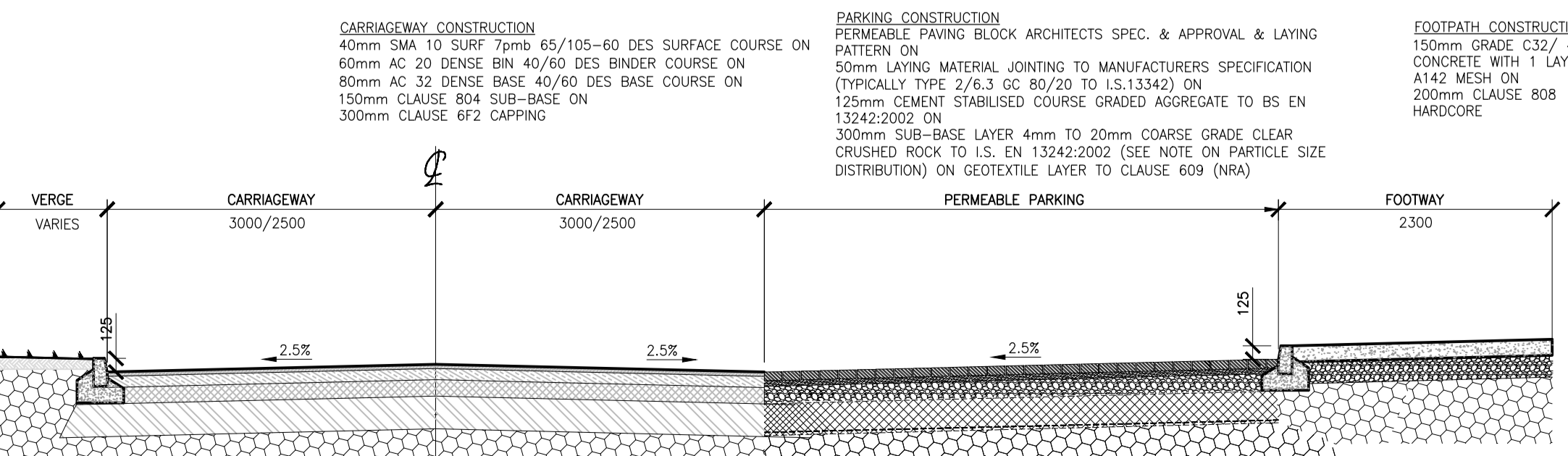

TYPICAL CROSS SECTION THROUGH ESTATE ROADS
SCALE 1:50

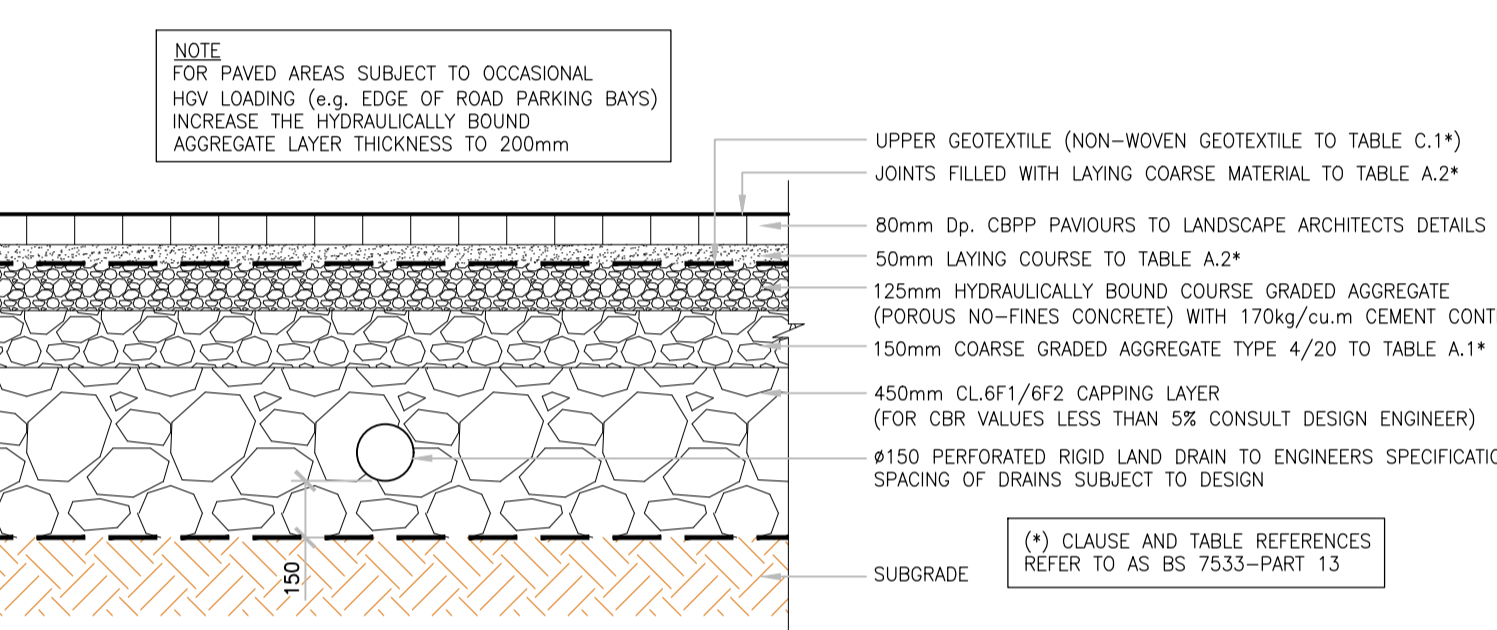
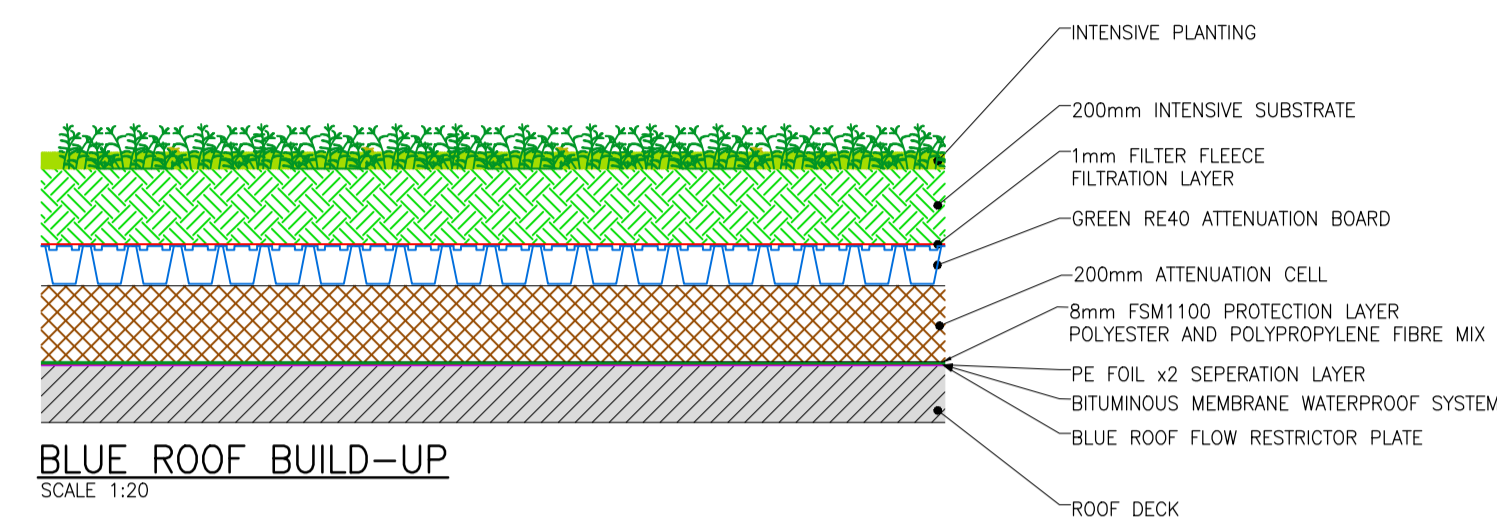

PERMEABLE PAVING TO CAR PARKING BAYS
SCALE 1:20

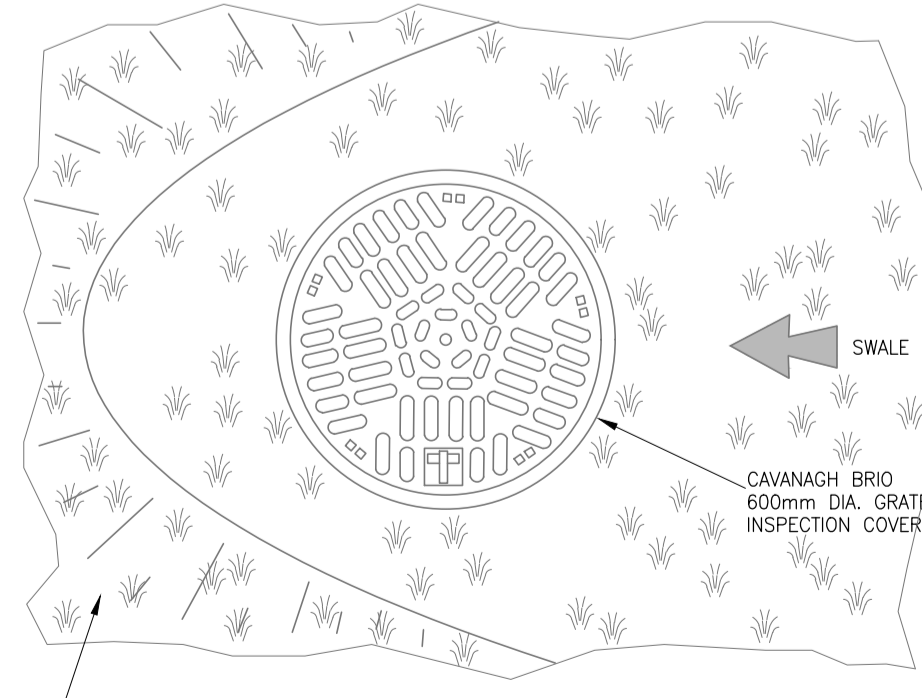
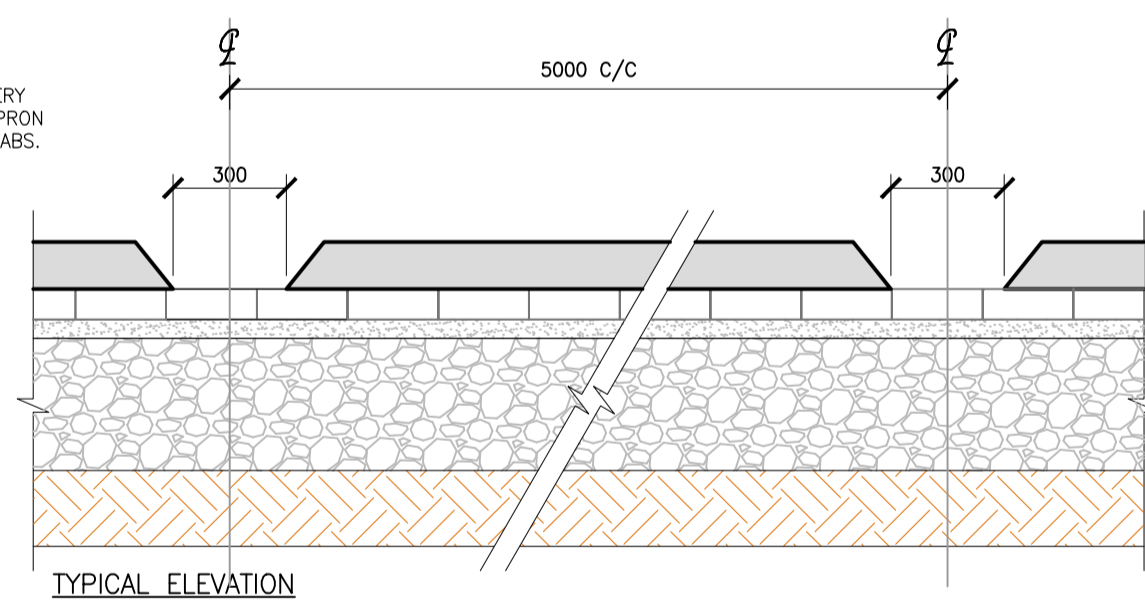

GRADED MANHOLE PLAN DETAIL D.
SCALE: N.T.S.

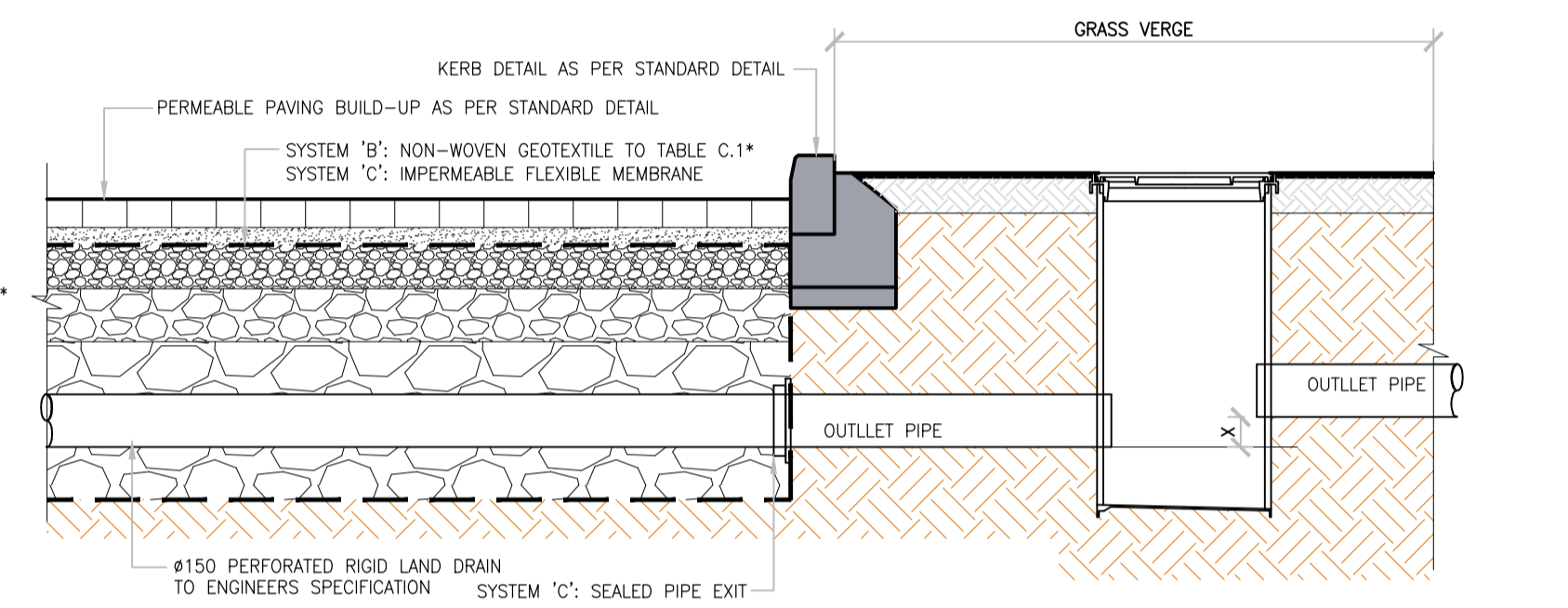
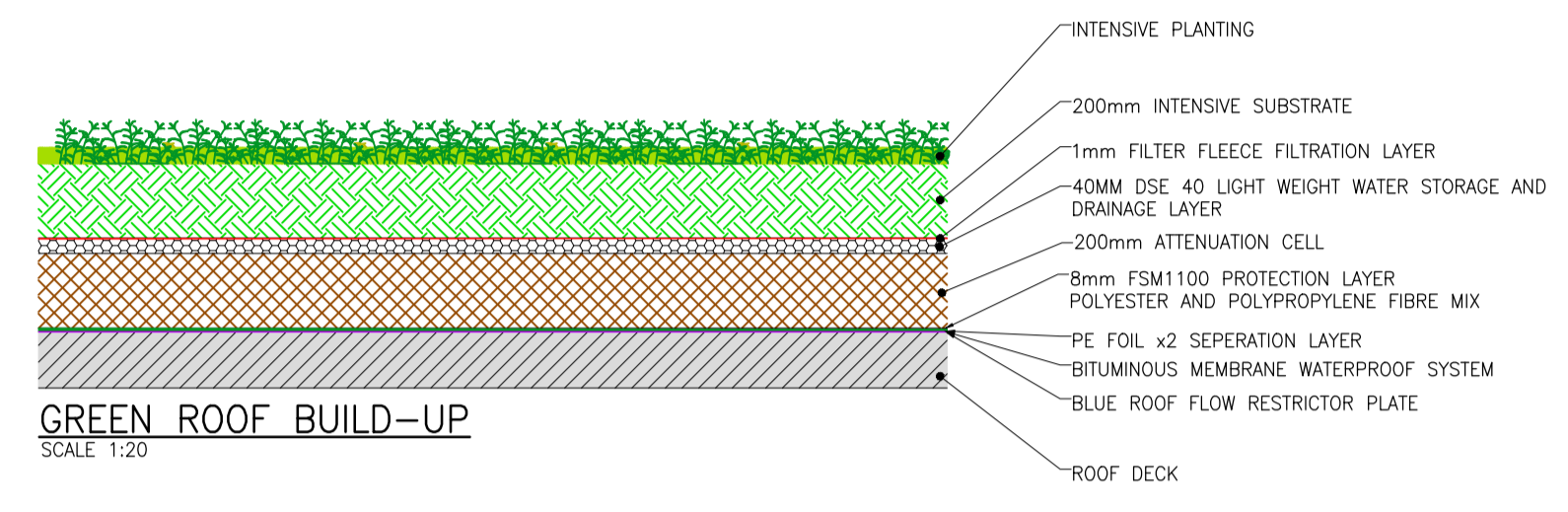

TYPICAL PERMEABLE PAVING OUTLET DETAIL
SCALE 1:20

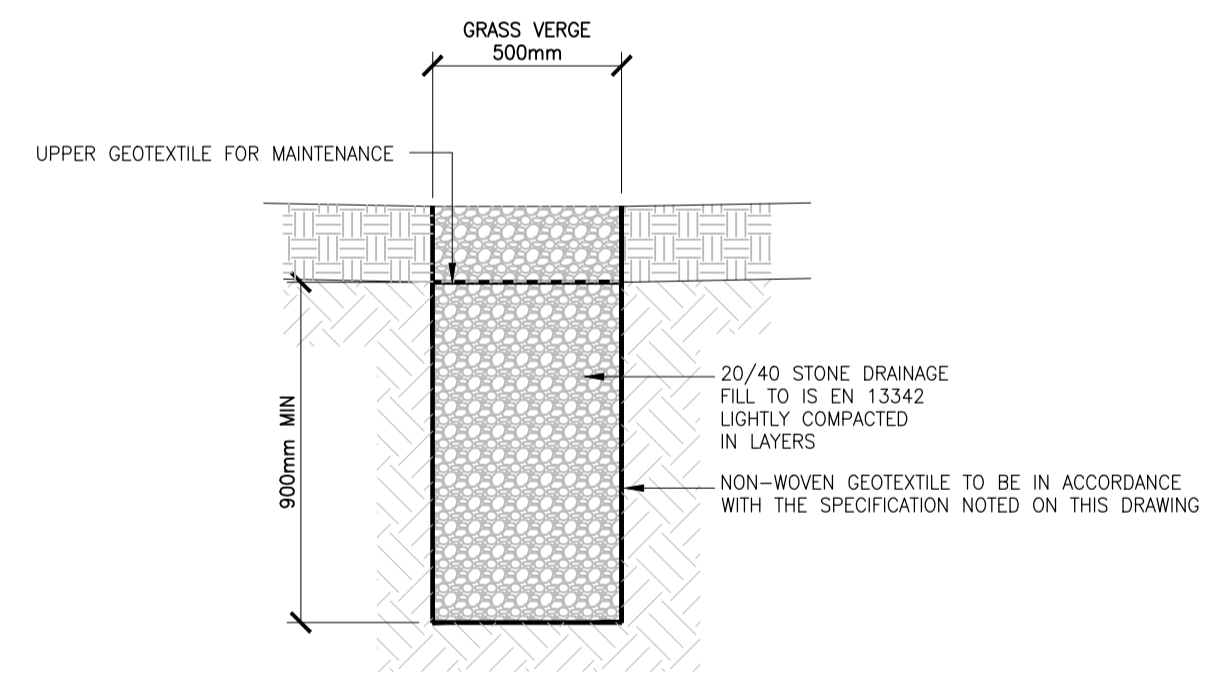

TYPICAL SECTION THROUGH RAINGARDEN/BIORETENTION AREA
SCALE 1:20

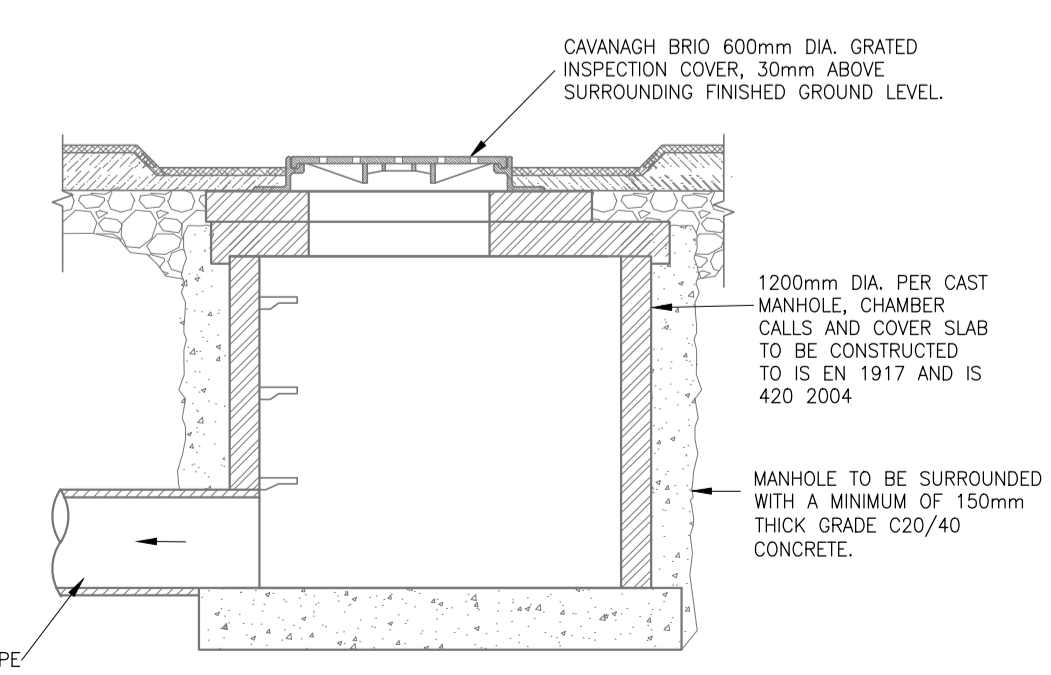

GRADED MANHOLE INLET CHAMBER - CROSS-SECTION
SCALE: N.T.S.

2	ISSUED FOR PLANNING	30.05.24	SL	DW
1	ISSUED FOR INFORMATION	28.05.24	KA	DW
0	ISSUED FOR INFORMATION	08.03.24	KA	PB
REV	DESCRIPTION	DATE	BY	CHK

STATUS

P3 - PLANNING

ADR
MALONE O'REGAN CONSULTING ENGINEERS

Unit 2B Richview Office Park, Clonskeagh, DUBLIN 14 D14 XT57

T: +353 1 260 2655
E: dublin@moroe.ie
W: www.maloneoregan.ie

Offices also in:
GALWAY T: +353 91 531 069 E: galway@moroe.ie
WATERFORD T: +353 51 876 855 E: waterford@moroe.ie

CLIENT

SOUTH DUBLIN COUNTY COUNCIL

JOB NAME

SOCIAL HOUSING PPP BUNDLE 4&5 - KISHOGUE, LUCAN

DRG. NAME

SUDS DETAILS SHEET 1

JOB REF	SHEET	SCALE	DATE	BY	ENG	APP	REV.
23006	A1	AS SHOWN	MAY'2024	SL	KA	PB	2

DRG. NO.

SHB5-CSD-DR-MOR-CS-P3-151