

**AREA TYPE:**

- 2 BED APARTMENT TYPE A-2B4P-1
- 2 BED APARTMENT TYPE A-2B4P-12
- CIRCULATION
- SERVICES

**GENERAL NOTES**

DO NOT SCALE FROM DRAWINGS. WORK TO FIGURED DIMENSIONS ONLY. ARCHITECT TO BE NOTIFIED OF ANY DISCREPANCIES.  
 THIS DRAWING TO BE READ IN CONJUNCTION WITH ALL ARCHITECT'S DRAWINGS, SPECIFICATIONS CONSULTANTS' DESIGN TEAM DRAWINGS AND SPECIFICATIONS.

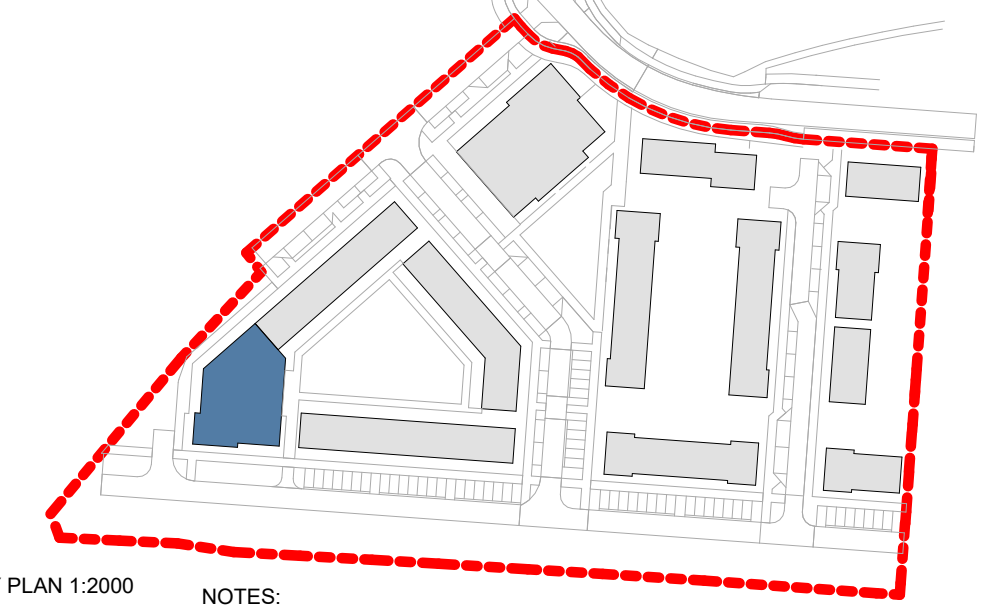

KEY PLAN 1:2000

NOTES:

PLEASE REFER TO MALONE O'REGAN CONSULTING ENGINEERS FOR ALL STRUCTURAL DRAWINGS AND DETAILS  
 PLEASE REFER TO SEMPLE MCKILLOP CONSULTING ENGINEERS DRAWINGS FOR ALL MECHANICAL & ELECTRICAL DETAILS for the following:-  
 - All proposed Mechanical Ventilation details  
 - AOV's min clear opening 1.5m to specialist details  
 - SVP drop locations & details  
 - Electrical layout & Lift Services specification  
 - Fire detection system specification & details throughout  
 - Escape lighting specification & details & exit SIGNAGE  
 IMPORTANT NOTE:  
 PLEASE REFER TO MITCHELL+ ASSOCIATES DRAWINGS/ REPORT FOR LANDSCAPING DETAILS

NOTE:

As an alternative to the foregoing, products which satisfy the equivalent European standards in TDG Part B 2022 may be used.

Allow for a 300x300mm access hatch in each apartment for hrv unit maintenance

NOTE 1:  
 All pipes passing through fire resisting construction to be firestopped.

Please read in conjunction with MCORM detail drawings and specifications.

**Area Schedule (Apartment Area)**

Apartment Type	Area	Count
----------------	------	-------

2 BED APARTMENT TYPE A-2B4P-1		
2 BED APARTMENT TYPE A-2B4P-1	78 m <sup>2</sup>	17

2 BED APARTMENT TYPE A-2B4P-12		
2 BED APARTMENT TYPE A-2B4P-12	86 m <sup>2</sup>	6

TOTAL: 23

NO. OF FLOORS: 6 STOREYS

GROUND FLOOR:  
 BICYCLE STORES : 25 SPACES

GROSS AREA : 2 515m<sup>2</sup> RESIDENTIAL

NET AREA : 1 842m<sup>2</sup> RESIDENTIAL

LEGEND

<span style="color: red;">*</span>	DUAL ASPECT UNIT
<b>UNIT X</b>	UNIT NUMBER
<b>Xm<sup>2</sup></b>	UNIT AREA m <sup>2</sup>
	LEVEL HEIGHT
<b>ST</b>	STORAGE
	OUTLINE OF STRUCTURE ABOVE

REV	DATE	DESCRIPTION	JH
A	28/06/2024	General Updates	JH

**FOR PLANNING**

CLIENT:  
 NDDA on behalf of South Dublin County Council

PROJECT TITLE:  
 Proposed Part 8 Residential Development Kishoge, Lucan

DRAWING TITLE:  
 APARTMENT BLOCK A- FIRST FLOOR PLAN

DRN BY: JH | CHK BY: PMcN | SCALE @ A1: 1:100 | DATE: 28/06/2024 | REVISION: A | JOB NO: 23004

DRAWING NUMBER: SHB5-CSD-DR-MCORM-AR-P3-1102 | STATUS CODE: P3

No.1 Grantham Street, Dublin 8  
 D08 A69Y Tel: +353 (0)1 478 8700  
 Block 6, Central Business Park  
 Tallamore, County Offaly  
 R35 F9FB Tel: +353 (0)57 932 3867  
 website: www.mcorm.com  
 email: arch@mcorm.com

**MCORM**  
 ARCHITECTURE AND URBAN DESIGN

Figured dimensions only to be used. This drawing is copyright of MCORM Ltd. All information is shared as per approved use in accordance with I.S. 883:2017 for I.S. EN ISO 19650-2: 2018. If 'Status Code' above is empty, this information has been shared as Status Code S0 - Work in Progress (WIP) / Draft.