

GENERAL NOTES

DO NOT SCALE FROM DRAWINGS. WORK TO FIGURED DIMENSIONS ONLY. ARCHITECT TO BE NOTIFIED OF ANY DISCREPANCIES.

THIS DRAWING TO BE READ IN CONJUNCTION WITH ALL ARCHITECT'S DRAWINGS, SPECIFICATIONS CONSULTANTS' DESIGN TEAM DRAWINGS AND SPECIFICATIONS.

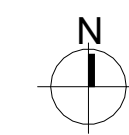
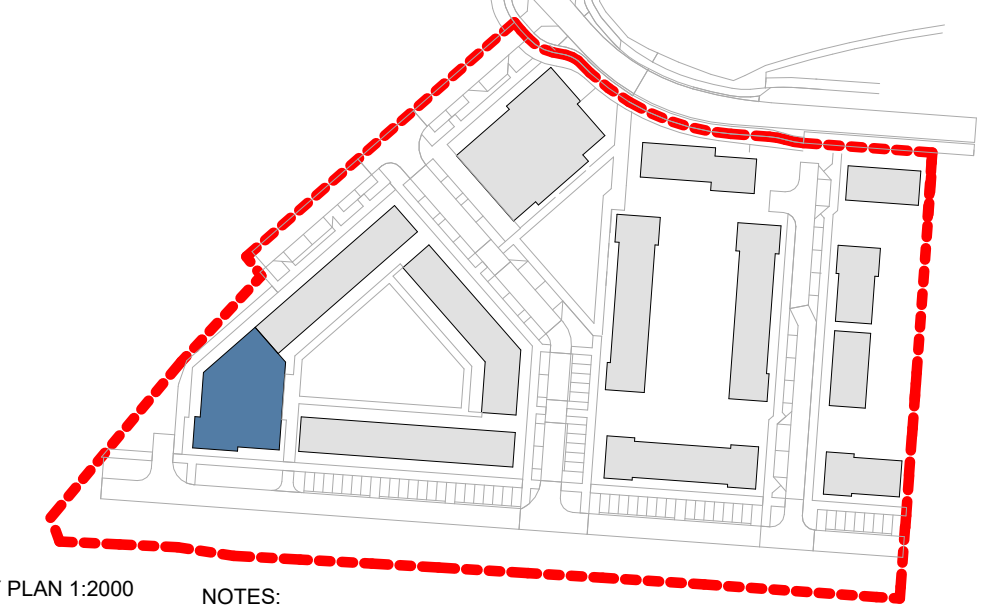

KEY PLAN 1:2000

NOTES:

PLEASE REFER TO MALONE O'REGAN CONSULTING ENGINEERS FOR ALL STRUCTURAL DRAWINGS AND DETAILS

PLEASE REFER TO SEMPLE MCKILLOP CONSULTING ENGINEERS DRAWINGS FOR ALL MECHANICAL & ELECTRICAL DETAILS

- All proposed Mechanical Ventilation details
- AOV's min clear opening 1.5m to specialist details
- SVP drop locations & details
- Electrical layout & Lift Services specification
- Fire detection system specification & details throughout
- Escape lighting specification & details & exit SIGNAGE

IMPORTANT NOTE:
PLEASE REFER TO MITCHELL+ ASSOCIATES DRAWINGS/ REPORT FOR LANDSCAPING DETAILS

NOTE:

As an alternative to the foregoing, products which satisfy the equivalent European standards in TDG Part B 2022 may be used.

Allow for a 300x300mm access hatch in each apartment for hrv unit maintenance

NOTE 1:
All pipes passing through fire resisting construction to be firestopped.

Please read in conjunction with MCORM detail drawings and specifications.

Area Schedule (Apartment Area)		
Apartment Type	Area	Count

2 BED APARTMENT TYPE A-2B4P-1		
2 BED APARTMENT TYPE A-2B4P-1	78 m ²	17

2 BED APARTMENT TYPE A-2B4P-12		
2 BED APARTMENT TYPE A-2B4P-12	86 m ²	6

TOTAL: 23

NO. OF FLOORS: 6 STOREYS

GROUND FLOOR:
BICYCLE STORES : 25 SPACES

GROSS AREA : 2 515m² RESIDENTIAL

NET AREA : 1 842m² RESIDENTIAL

LEGEND	
* UNIT X	DUAL ASPECT UNIT
Xm ²	UNIT NUMBER
	UNIT AREA m ²
⬆	LEVEL HEIGHT
ST	STORAGE
- - -	OUTLINE OF STRUCTURE ABOVE

REV	DATE	DESCRIPTION	JH
A	28/06/2024	General Updates	JH

FOR PLANNING

CLIENT:
NDFA on behalf of South Dublin County Council

PROJECT TITLE:
Proposed Part 8 Residential Development Kishoge, Lucan

DRAWING TITLE:
APARTMENT BLOCK A- ROOF PLAN

DRN BY:	CHK BY:	SCALE @ A1:	DATE:	REVISION:	JOB NO.:
JH	PMcN	1:100	28/06/2024	A	23004

DRAWING NUMBER:	STATUS CODE:
SHB5-CSD-DR-MCORM-AR-P3-1107	P3

MCORM
ARCHITECTURE
AND URBAN DESIGN

No.1 Grantham Street, Dublin 8
D08 A49Y Tel: +353 (0)1 478 8700
Block 6, Central Business Park
Tullamore, County Offaly
R35 F9F8 Tel: +353 (0)57 932 3867
website: www.mcorm.com
email: arch@mcorm.com

Figured dimensions only to be used. This drawing is copyright of MCORM Ltd. All information is shared as per approved use in accordance with I.S. IIA:2021 (to I.S. EN ISO 19550-2: 2018 'B' Status Code' above is empty, this information has been shared as Status Code S0 - Work in Progress (WIP) / Draft.

07-ROOF LEVEL

SCALE: 1 : 100

