

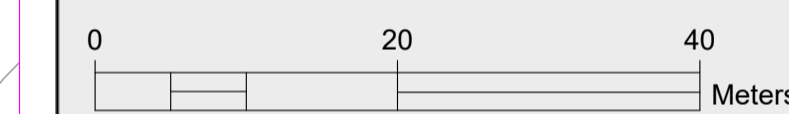

Director:
Mick Mulhern

Senior Engineer:
John Hegarty

- LEGEND:
- Foul Sewer —●— Red
 - Surface Water Sewer —●— Green
 - Watermain —●— Blue
 - Fire Hydrant ● Sluice Valve
 - Air Valve ● Scour Valve
 - Foul Water Under 225mm —●— Grey
 - Surface Water Under 225mm —●— Grey
 - Site Boundary — Red
 - Open Space ■
 - Roads and Footpaths to be TIC ■
 - Areas to Remain Private/Management Co. ■
 - Wayleaves ■



Revision	Description	Date

Notes:
This drawing does not constitute a recommendation to have an estate taken in charge.
This drawing refers to the taking in charge of the roads and services as indicated in colour.
All sewers are 225mm dia. unless otherwise indicated.
Scaled dimensions not to be used.
Length of roads as on attached road schedule.
Boundary treatments to roads taken in charge i.e. walls and/or railings are not included in, and are not part of the taking in charge procedure.

Location:
Wilkins Court
Walkinstown
Dublin 12

Drawing Title:
Taking in Charge Scheme

Drawn by: PL	O.S. Reference: 3327-19, 3327-20
Surveyed by: Roger Mullarkey	Scale: 1:500
Checked:	Date: 04/07/2023

Drawing Number:
BC-1455

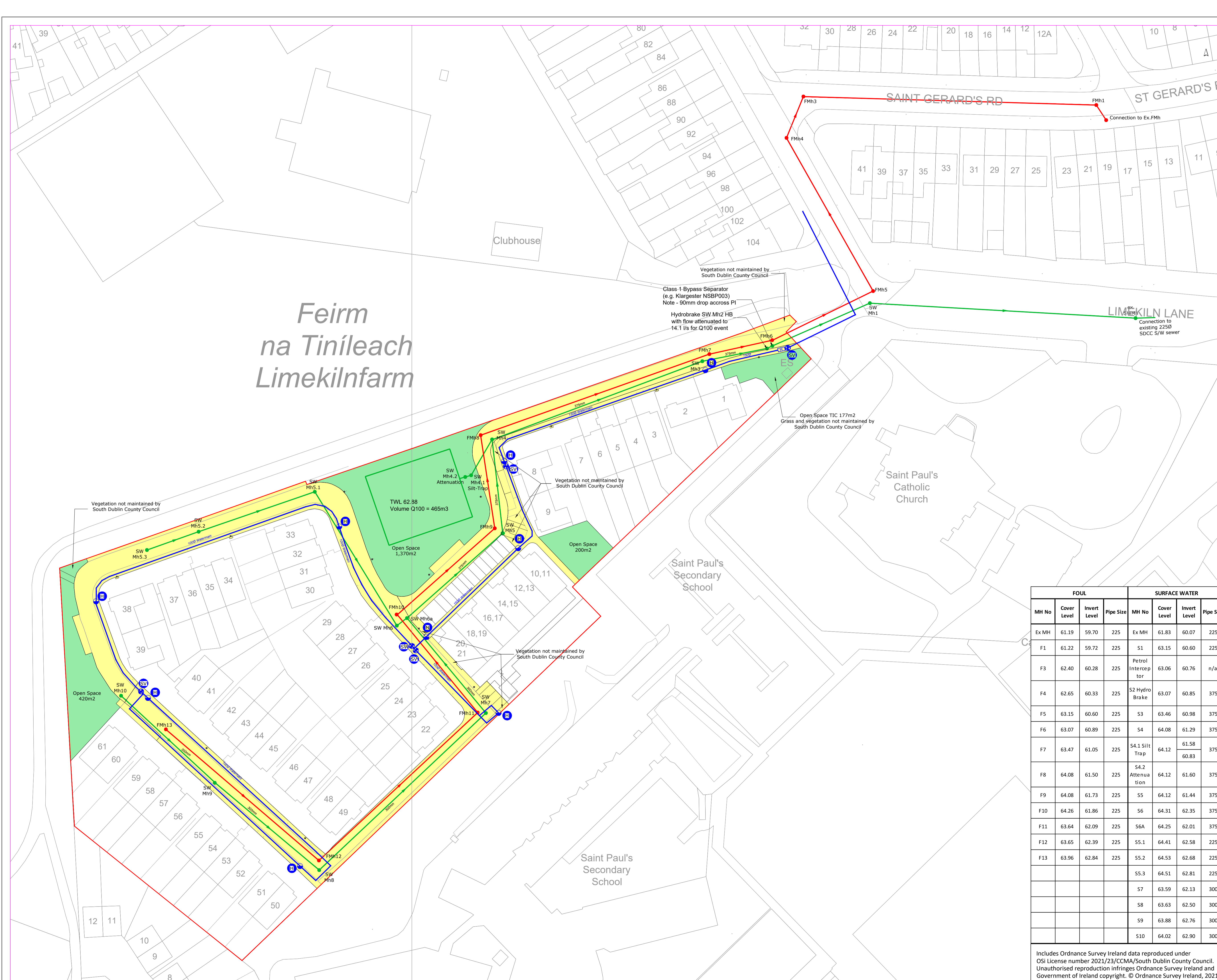

FOUL				SURFACE WATER			
MH No	Cover Level	Invert Level	Pipe Size	MH No	Cover Level	Invert Level	Pipe Size
Ex MH	61.19	59.70	225	Ex MH	61.83	60.07	225
F1	61.22	59.72	225	S1	63.15	60.60	225
F3	62.40	60.28	225	Petrol Interceptor	63.06	60.76	n/a
F4	62.65	60.33	225	S2 Hydro Brake	63.07	60.85	375
F5	63.15	60.60	225	S3	63.46	60.98	375
F6	63.07	60.89	225	S4	64.08	61.29	375
F7	63.47	61.05	225	S4.1 Silt Trap	64.12	61.58 / 60.83	375
F8	64.08	61.50	225	S4.2 Attenuation	64.12	61.60	375
F9	64.08	61.73	225	S5	64.12	61.44	375
F10	64.26	61.86	225	S6	64.31	62.35	375
F11	63.64	62.09	225	S6A	64.25	62.01	375
F12	63.65	62.39	225	S5.1	64.41	62.58	225
F13	63.96	62.84	225	S5.2	64.53	62.68	225
				S5.3	64.51	62.81	225
				S7	63.59	62.13	300
				S8	63.63	62.50	300
				S9	63.88	62.76	300
				S10	64.02	62.90	300

Includes Ordnance Survey Ireland data reproduced under OSI license number 2021/23/CCMA/South Dublin County Council. Unauthorised reproduction infringes Ordnance Survey Ireland and Government of Ireland copyright. © Ordnance Survey Ireland, 2021.